

35135—KLOPP & BARTLETT CO., PRINTING, LITHOGRAPHING, STATIONERY, OMAHA, IOWA

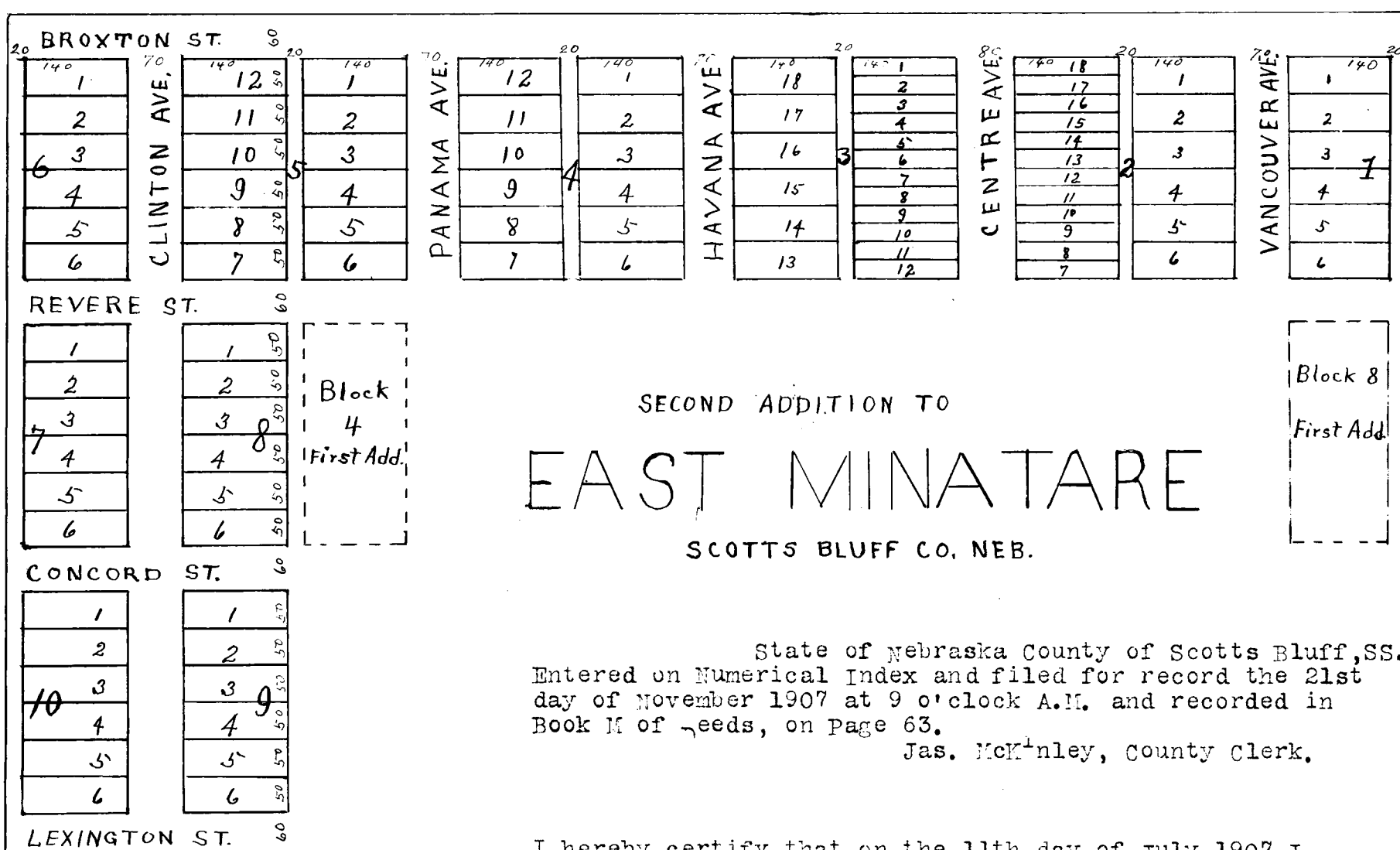

SECOND ADDITION TO
EAST MINATARE
 SCOTTS BLUFF CO. NEB.

State of Nebraska County of Scotts Bluff, SS.
 Entered on Numerical Index and filed for record the 21st day of November 1907 at 9 o'clock A.M. and recorded in Book M of Deeds, on Page 63.
 Jas. McKinley, County Clerk.

I hereby certify that on the 11th day of July 1907 I surveyed Second Addition to East Minatare situated on a part of the NE $\frac{1}{4}$ of Sec. 7, T. 21 N. R. 53 W. as shown by the foregoing plat which is a correct delineation of said survey drawn to a scale of 200 feet to an inch. The avenues and streets are extensions of those of same names in the original town and first addition, Broxton St is parallel with Reeves St. and Clinton Ave. is parallel with Panama Ave. Burr Oak stakes are driven well into the ground at the front corners of each lot. The width of streets avenues and alleys and dimensions of lots are indicated in feet by red figures. Each lot and block bears its own number.
 Witness my hand this 28th day of July 1907.

Anselmo B. Smith, Surveyor.

This certifies: That the Lincoln Land company, a Corporation duly organized and existing under the laws of the state of Nebraska, is the owner in fee of that part of the North-east quarter (NE $\frac{1}{4}$) of section, numbered Seven (7), in Township numbered Twenty-one (21) North, of range numbered Fifty-three (53) West of the sixth principal Meridian, on which the Second Addition to East Minatare is located as is shown on the foregoing plat and Surveyor's Certificate except the following which have been deeded by the Lincoln Land Company as follows:

- Lot 6 Block 2, to Oscar W. Seyfer and
- Lot 6 Block 4 to E. E. Clough.

That said owner has caused said land to be surveyed and platted as said Second Addition to East Minatare as shown by said plat and surveyor's certificate, that the streets, avenues and alleys indicated on said plat and mentioned in said surveyor's certificate are hereby dedicated to the Public use.

In testimony whereof: The said Lincoln Land company has caused this instrument to be signed by its president, countersigned by its secretary, and the corporate seal of said company to be hereunto affixed this 14th day of November, A.D. 1907. Executed in Duplicate. Countersigned.

A. B. Minor, secretary.
 Witness signature of president.
 H. H. Herd, (Corporate seal)

State of Nebraska,)
) SS. Be It Shown: That on this 14th day of November A.D. 1907,
 Lancaster county.) before me, a Notary public in and for said County, personally
 who is personally known to me to be the identical person whose name is subscribed to the
 foregoing instrument as said president, and then and here acknowledged the said instrument
 and the execution thereof to be his voluntary act and deed and the voluntary act and deed of
 the said Company.

Witness my hand and Notarial seal on the day last above written.
 (SEAL) My Commission expires November 24, 1912. H. H. Herd, Notary Public.

