

# DEED RECORD X, SCOTTS BLUFF COUNTY

10224—KLOPP & BARTLEY CO., PRINTING, STATIONERY, COUNTY AND SCHOOL SUPPLIES, OMAHA

containing 160 acres Subject to the right of way of the Enterprise Ditch, Tri-State Land Company Ditch and the C.B. & Q. Railroad Company

with the appurtenances.

TO HAVE AND TO HOLD THE SAME unto the said Sheridan A. Gummere his heirs and assigns, and to them and their use and behoof forever.

IN TESTIMONY WHEREOF, I have as such Sheriff, hereunto set my hand this 16th day of September, A. D. 1916.

Executed and delivered in the presence of M. H. McHenry

F. O. Aaron Sheriff of Scotts Bluff County, Nebraska.

STATE OF NEBRASKA, )  
County of Scotts Bluff. ) ss.

On this 16th day of September 1916, before me, the undersigned Clerk of the District Court in and for said county, personally appeared the said F. O. Aaron Sheriff of said county, to me personally known to be the identical person who signed the foregoing instrument as grantor, and he acknowledged the same to be his voluntary act and deed, as such sheriff, for the uses and purposes therein set forth.

M. H. McHenry  
Clerk of the District Court.



#####

Anna Miller & Husband

to

The Public Use

STATE OF NEBRASKA, Scotts Bluff County, ss.

Entered on Numerical Index and filed for record the 5 day of Dec. 1916, at 11 o'clock A. M. and recorded in Book X of Deeds on Page 659.

J. H. Ferguson  
Register of Deeds.

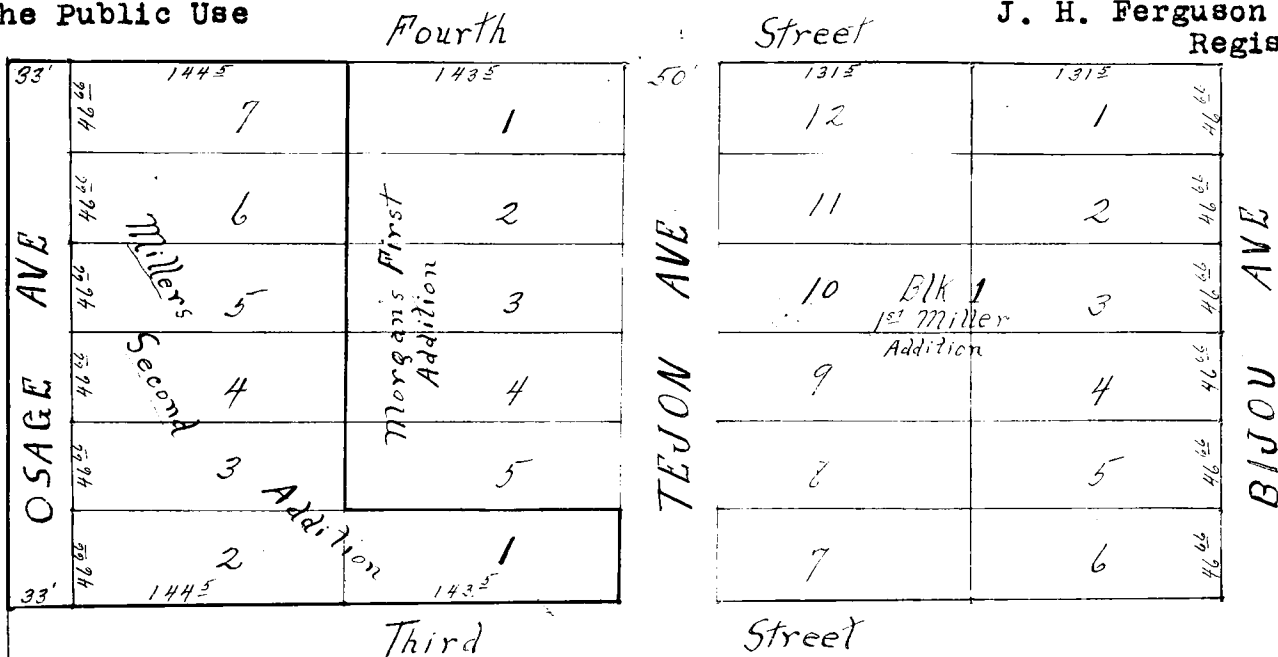

Scale 1"=100'

SECOND MILLER ADDITION

I hereby certify that on the 20th day of March, 1916, I surveyed the Second Miller Addition to Scottsbluff, situated on a part of Sec. 24, T 22 N. R 55 W., described as follows: Beginning at a point 660 feet North of the S.W. Cor. of said section, thence North a distance of 280 feet, thence East 177<sup>5</sup> feet, thence South 233.33 feet, thence East 143<sup>5</sup> feet, thence South 46<sup>66</sup> feet, thence West 288 feet to the point of beginning; that the above plat is a correct delineation of said survey drawn to a scale of 1 inch to 100 feet.

2x2" Pine stakes are driven well into the ground at the front corners of the lots. The width of the streets and the dimensions of lots are indicated on the plat in feet and decimals. Each lot bears its own number.

WITNESS my hand this 20th day of November, A. D. 1916.

A. L. Slezer  
Surveyor.

660'

This certifies that Anna Miller and Albert D. Miller, wife and husband are the owners of that part of Sec. 24, T. 22 N. R 55 W. of the 6th P.M., described as follows: Beginning at a point 660 feet North of the S.W. corner of the said section, thence North a distance of 288 feet, thence East 177<sup>5</sup> feet, thence South 233.33 feet, thence East 143<sup>5</sup> feet, thence South 46<sup>66</sup> feet, thence West 288 feet to the point of beginning, on which Second Miller Addition to Scottsbluff is located as shown by the foregoing plat and surveyors certificate, that the above or foregoing subdivision of that part of Sec. 24, T 22 N., R 55 W. as described above and as appears on this plat is made with the free consent and in accord with the desire of the undersigned owners and proprietors.

IN TESTIMONY WHEREOF we have hereunto set our hand, this 27th day of November, A. D. 1916.

Anna Miller  
Albert D. Miller

# DEED RECORD X, SCOTTS BLUFF COUNTY

STATE OF NEBRASKA, }  
Scotts Bluff County. } ss.

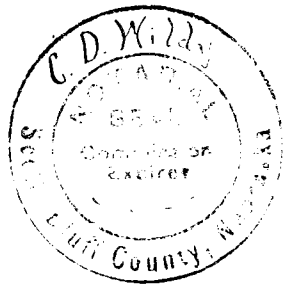

On this 27th day of November, 1916, before me, the undersigned a notary public in and for said county, personally came Anna Miller and Albert D. Miller, wife and husband, to me personally known to be the identical persons whose names are affixed to the above instrument and acknowledged the execution thereof to be their voluntary act and deed for the purposes therein expressed.

WITNESS my hand and notarial seal the day and year last above written.

C. D. Wildy  
Notary Public.

#####

Otto E. Moline  
to  
James S. Tarr

STATE OF NEBRASKA, Scotts Bluff County, ss.  
Entered on Numerical Index, and filed for record in the office of the Register of Deeds of said County, the 8th day of December, 1916, at 8 o'clock and -- minutes A. M., and duly recorded in Book X of Deeds on page 660.  
J.H. Ferguson Register of Deeds.

KNOW ALL MEN BY THESE PRESENTS:

That I, Otto E. Moline, a single man, of the County of Scottsbluff, and State of Nebraska, in consideration of the sum of One dollar and other valuable considerations in hand paid by James S. Tarr, of Scottsbluff County, State of Nebraska, do hereby sell and convey unto the said James S. Tarr, the following described premises, situated in Scottsbluff County, State of Nebraska, to-wit:

Lot numbered Two . . . . . (2)  
in Block numbered Six . . . . . (6)  
in the First Addition of the town of Morrill, according to the recorded plat thereof.

together with all appurtenances thereunto belonging, and Otto E. Moline hereby covenant that the said premises are free and clear from all liens and encumbrances and I covenant to warrant and defend the said premises against any acts of said parties of the first part. And the said Otto E. Moline hereby relinquishes all his rights, title and interests of every nature in and to the above described premises.

Signed this 4th day of December, A. D. 1916.

In Presence of  
H. C. Karpf

Otto E. Moline

STATE OF NEBRASKA, }  
Scottsbluff County. } ss.



On this 4th day of December, A. D. 1916, before me the undersigned H. C. Karpf, a Notary Public, duly commissioned and qualified for and residing in said County, personally came Otto E. Moline, a single man, to me known to be the identical person whose name \_\_\_ affixed to the foregoing conveyance as grantor and acknowledged the execution of the same to be his voluntary act and deed.

Witness my hand and Notarial Seal the day and year last above written.

H. C. Karpf  
Notary Public.

My commission expires the 4 day of Dec. 1916.

#####