

DEED RECORD R, SCOTTS BLUFF COUNTY.

LOPP & WELLET CO. Printing, Lithographing and County Supplies, Omaha.

WEST LAWN ADDITION

to

GERING.

I, A. B. McCoskey, do hereby certify that on the 14th day of February, 1912, I surveyed WEST LAWN Addition to the town of Gering, which is a part of the SE $\frac{1}{4}$  of the NW $\frac{1}{4}$  of Section 2, T. 21 N., R. 55 W., in Scotts Bluff County, Nebraska, described as follows: Beginning at a point 50 feet North of the center of said Section 2, thence West parallel to the center line of Euclid Ave. 840 feet, thence North 1270 feet, thence East 840 feet, thence South 1270 feet to the place of beginning; that the above described tract is subdivided into blocks, lots, streets and alleys as shown by the accompanying plat; that oak stakes 2 inches square are driven firmly into the ground at the corners of each block and that fir stakes 2 inches square are driven at the front corners of each lot; that the widths of the Streets and Alleys

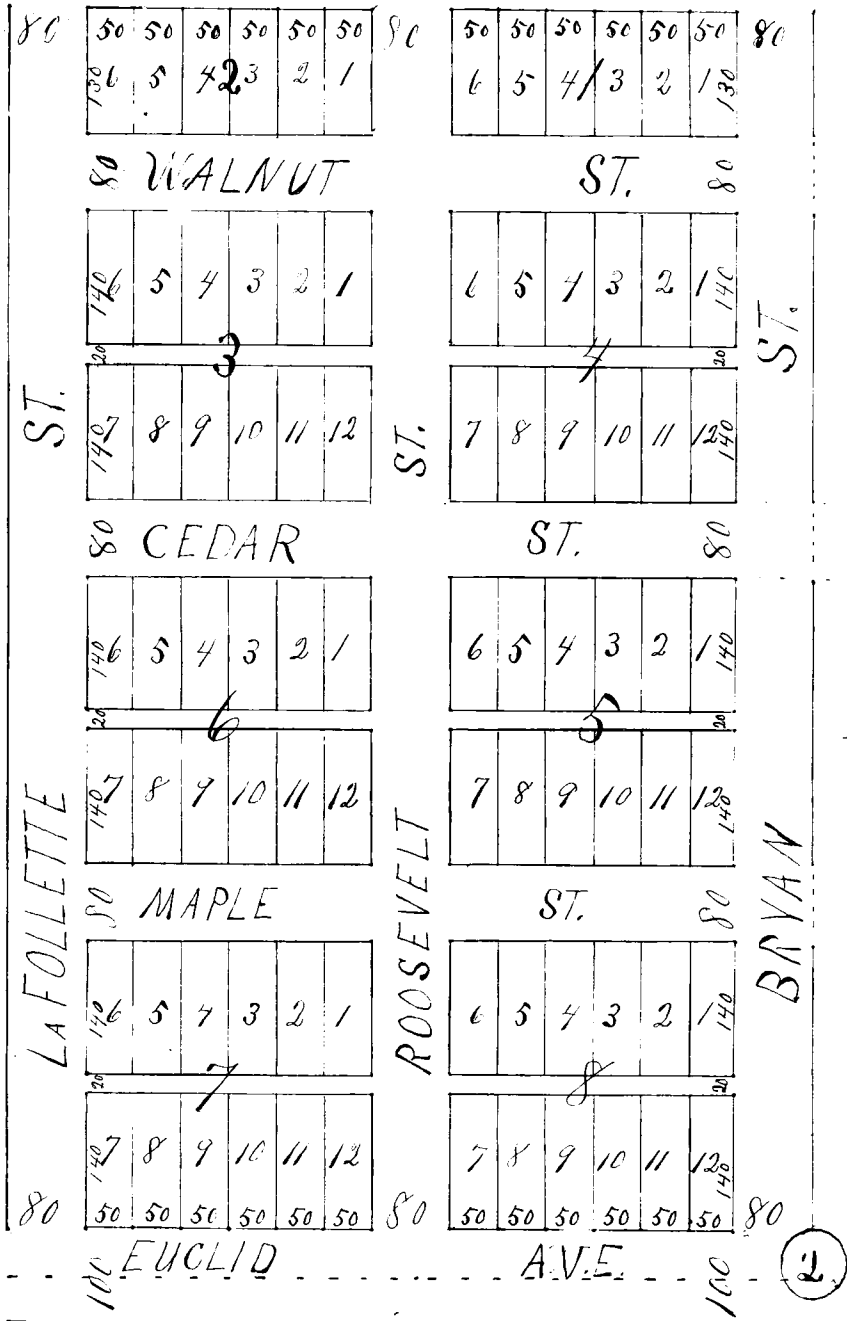

and the numbers of the lots and blocks are as shown by figures on the plat. Each lot and block bears its own number.

A. B. McCoskey,  
Surveyor.

This Certifies, That Frank M. Sands and Phena A. Sands husband and wife and James H. Sands, single are the owners in fee of that part of the South-east quarter ( SE $\frac{1}{4}$  ) of the North-west Quarter ( NW $\frac{1}{4}$  ) of Section Two (2), in Township Twenty-one (21), North of Range Fifty-five (55) West of the Sixth Principal Meridian, Scotts Bluff County, Nebraska, on which West Lawn Addition to Gering, is located as shown on the foregoing plat and Surveyor's Certificate.

That said owners have caused said land to be surveyed and platted as said West Lawn Addition to Gering, as shown by said plat and Surveyor's Certificate; that the Streets, Avenues and Alleys indicated on said plat and mentioned in said Surveyor's Certificate are hereby dedicated to the Public Use.

Witness our hands and seal this 28 day of Febr. A. D. 1912.

One witness as to Frank M. Sands and Phena A. Sands.  
M. J. Huffman  
One witness as to James H. Sands,  
M. J. Huffman

Frank M. Sands  
Phena A. Sands  
James H. Sands

DEED RECORD R, SCOTTS BLUFF COUNTY.

53981—KLOPP & BARTLETT CO., Printing, Lithographing and County Supplies, Omaha.

The State of Nebraska )
) SS.
Scotts Bluff County )

BE IT KNOWN, that on this 28 day of February, A. D. 1912, before me M. J. Huffman a Notary Public in and for said County, personally appeared Frank M. Sands and Phena A. Sands, husband and wife to me personally known to be the identical persons described in and whose names are affixed to the foregoing instrument as grantors, and they severally acknowledged the same to be their voluntary act and deed.

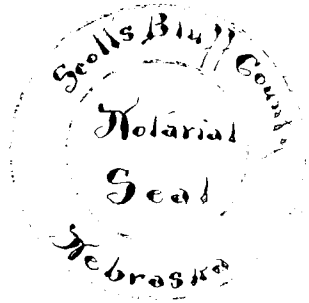

IN TESTIMONY WHEREOF, I have hereunto set my hand and Notarial Seal at Gering, in said County the day and year last above written.

M. J. Huffman,

My commission expires September 21, 1913. Notary Public.

The State of Nebraska )
) SS.
Webster County )

On this the 22nd day of March, 1912, before me, personally came James H. Sands, a single man, to me known to be the individual person described in and who executed the foregoing instrument, and he acknowledged to me that he voluntarily and of his free will executed the same. To be his voluntary act and deed.



Issac B. Colvin, Notary Public.

My commission expires September 18, 1917.

State of Nebraska )
Scotts Bluff County ) SS.
of Deeds on page 38.

Entered on Numerical Index and filed for record the 3 day of April, 1912 at 1:10 o'clock P. M., and recorded in Book "R"

J. H. Ferguson, County Clerk.

#####

C. S. Andrews and wife
to
Walter S. Andrews.

State of Nebraska, Scotts Bluff County, SS.
Entered on Numerical Index and filed for record April 6th, 1912 at 1:30 o'clock P. M. and recorded in Book "R" of Deeds on page 39.
J. H. Ferguson, County Clerk.

WARRANTY DEED.

.....

KNOW ALL MEN BY THESE PRESENTS:

That We, C. S. Andrews, and Delilah Andrews, husband and wife of Scotts Bluff County, and State of Nebraska, in consideration of love and affection and the sum of One and no/100 Dollars in hand paid by Walter S. Andrews of Scotts Bluff County and State of Nebraska do hereby sell and convey unto the said Walter S. Andrews the following described premises, situate in the County of Scotts Bluff and State of Nebraska, to-wit:

All that portion of the North West quarter of Section Twenty four, in Township Twenty two, North, Range number fifty five, west of the Sixth Principal Meridian, lying east and north of the line of the Winters Creek Ditch as the same is now constructed over and across said North West quarter, and more particularly described as follows, to-wit: Beginning at the North East corner of said North West quarter and extending thence west about forty rods to the North and East line of the right-of-way of the Winter Creek Ditch, thence extending Southeasterly along the said North and East line of said right-of-way about seventy five rods, to the point where said right of way line intersects the east line of said North West quarter of Section Twenty-four, aforesaid, and thence North along said East line of said North west quarter, aforesaid, about forty-five rods, to the point of beginning, and containing about eight and forty-one hundredths acres. Subject however, to all legal highways.