

582

STATE OF NEBRASKA)
SCOTTSBLUFF COUNTY) SS
ENTERED ON NUMERICAL INDEX AND FILED FOR
RECORD THE 14th DAY OF OCTOBER 1952 AT 1:01
O'CLOCK P.M. AND RECORDED IN BOOK 73 OF DEEDS
ON PAGE 582.

57531

Alma L. Truax
REGISTER OF DEEDS



WESTMOOR THIRD ADDITION

SCALE 1" = 100'

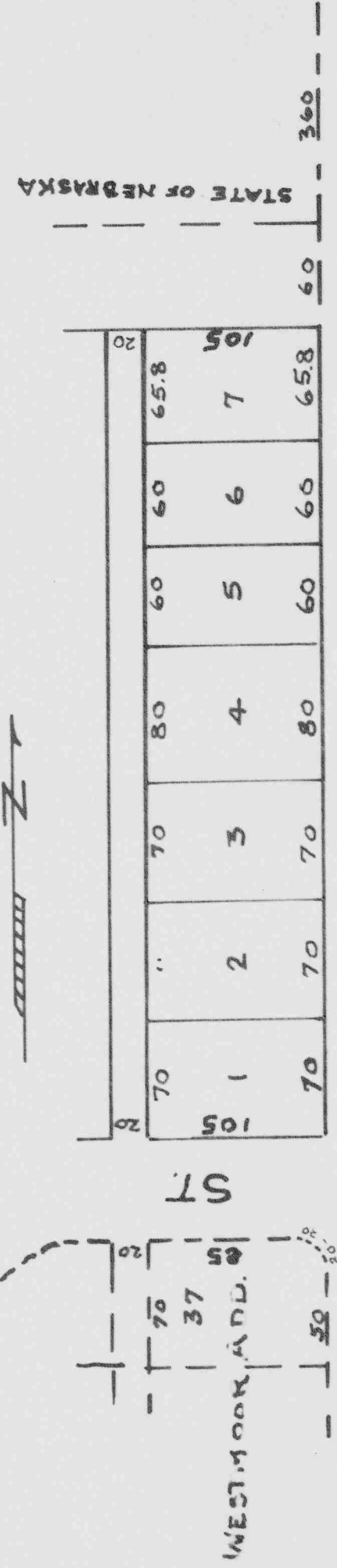

9 AVE I

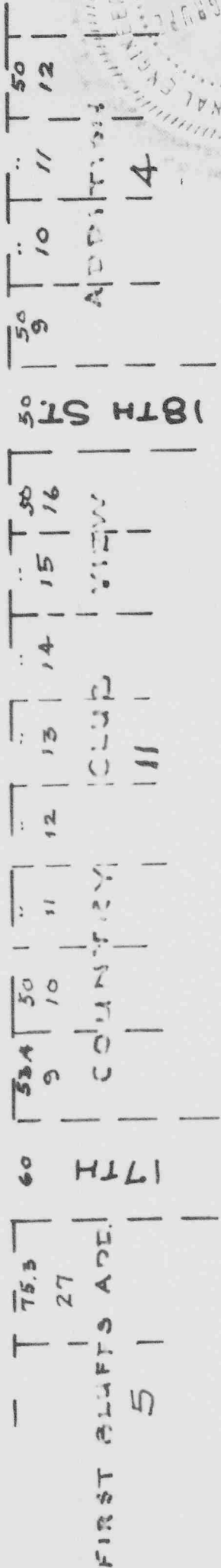

ENGINEER'S CERTIFICATE

STATE OF NEBRASKA)
SCOTTS BLUFF COUNTY)

I, E. Y. GRUBE, a competent surveyor, of Scotts Bluff County, Nebraska, hereby certify that I have accurately surveyed WESTMOOR THIRD ADDITION to the City of Scottsbluff, Nebraska, situated on part of the East Half of the Southeast Quarter of Sec. Twenty-two, Township Twenty-two (22) North, Range Fifty-five (55) West of the 6th P.M., Scotts Bluff County, Nebraska, more particularly described as follows: Beginning at a point 33 feet West of the East line of Section 22 T22N R55 West of the 6th P.M. and 1352.7 feet North of the South line of Said Section 22; thence North 475.8 feet along the West line of Avenue I; thence West 125 feet; thence South 475.8 feet to the North Line of 17th St; thence East 125' along the North line of 17th St. to the point of beginning. That the above Plat is a correct delineation of said survey drawn to a scale of 100 feet to an inch. Iron pins are driven into the ground at the front and rear corners of each lot. Each lot bears it's own number.

E. Y. Grube

WITNESS MY HAND this 12th day of September 1952.

Surveyor-Reg. No. 5-10

We, the undersigned, Frank A. Schmid and C. Emma Schmid, husband and wife, being the owners of a part of the East Half of the Southeast Quarter (24 1/4 Sec) of Section Twenty-two (22), Township Twenty-two (22) North, Range Fifty-five (55) West of the 6th P.M., Scotts Bluff County, Nebraska, more particularly described as follows: Beginning at a point 33 feet West of the East line of Section twenty-two (22), T22N, R55W of the 6th P.M. and 1382.7 feet North of the South line of said Section 22.; thence North 475.8 feet along the West line of Avenue I; thence West 125 feet; thence South 475.8 feet to the North line of 17th St; thence East 125 feet along the North line of the City of Scotts Bluff County, Nebraska, said land to be surveyed and platted as WESTMOOR THIRD ADDITION to the City of Scotts Bluff County, Nebraska, as shown by the above Plat and Surveyor's Certificate. we, hereby dedicate the Streets, Avenues, and Alleys designated upon and referred to in said Plat to the use and benefit of the public and we hereby annex and make said real estate, so shown on said Plat, a part of the City of Scotts Bluff County, Nebraska, to be known as WESTMOOR THIRD ADDITION to the City of Scotts Bluff County, Nebraska.

Dated this 13TH day of September, 1952. Frank A. Schmid
C. Emma Schmid

ACKNOWLEDGEMENT

STATE OF NEBRASKA)
 COUNTY OF SCOTTS BLUFF) ss:

Now on this 13TH day of September, 1952, before me the undersigned, a Notary Public, in and for said County, personally came Frank A. Schmid and C. Emma Schmid, husband and wife, to me known to be the identical persons whose names are affixed to the foregoing Plat and Dedication and acknowledged the same to be their voluntary act and deed. Witness my hand and Notarial Seal the day and year last above written.

Kenneth Alf Roberts
 NOTARY PUBLIC

ACCEPTANCE

The above Plat approved by the Planning Board of the City of Scottsbluff, Nebraska, this 7 day of Oct, 1952

W.S. Boston
 CHAIRMAN OF BOARD

The above Plat approved by the Mayor and City Council of the City of Scottsbluff, Nebraska, by RESOLUTION duly passed on 7TH day of OCTOBER, 1952.

Albert P. Hauke
 MAYOR

Attest: Loren C. Leonard