

NAME B
 GEN. 8
 PICT. 8
 COMMENTS 8

Situated in the Northwest Quarter of the Northeast Quarter of Section 24, Township 22 North, Range 55 West of the 6th P.M. Scotts Bluff County, Nebraska

Situated in the Northwest Quarter of the Northeast Quarter of Section 24, Township 22 North, Range 55 West of the 6th P.M. Scotts Bluff County, Nebraska

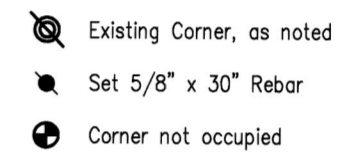

I, Kelly A. Beatty, a Nebraska Registered Land Surveyor hereby certify I have surveyed and prepared a plat of BLOCKS ONE THROUGH FIVE, SYKES ADDITION, AN ADDITION TO THE CITY OF SCOTTSBLUFF, SCOTTS BLUFF COUNTY, NEBRASKA. Situated in the Northwest Quarter of the Northeast Quarter of Section 24, Township 22 North, Range 55 West of the 6th P.M., Scotts Bluff County, Nebraska, more particularly described as follows:

Commencing at the northwest corner of the Northeast Quarter of Section 24, thence southerly on the west line of the Northeast Quarter of Section 24, a distance of 50.00 feet, to the point of intersection with the south right of way line of East 27th Street, as platted, said point also being the Point of Beginning, thence continuing southerly on said west line of the Northeast Quarter of Section 24, a distance of 817.52 feet, as measured, to the centerline of the Winters Creek Canal, thence a deflection angle left 69°-29'-13", on said centerline, a distance of 126.77 feet, thence a deflection angle left 15°-06'-30", on said centerline, a distance of 210.80 feet, thence a deflection angle right 34°-45'-20", on said centerline, a distance of 298.26 feet, thence a deflection angle left 39°-34'-48", on said centerline, a distance of 189.78 feet, thence a deflection angle left 11°-07'-13", on said centerline, a distance of 249.80 feet, thence a deflection angle right 15°-26'-31", on said centerline, a distance of 370.74 feet, to the point of intersection with the east line of the Northwest Quarter of the Northeast Quarter of Section 24, thence a deflection angle left 94°-54'-31", on the east line of the Northwest Quarter of the Northeast Quarter of Section 24, a distance of 1075.90 feet, to the point of intersection with the south right of way line of East 27th Street, thence a deflection angle left 90°-38'-55", on the south right of way line of East 27th Street, a distance of 1339.72 feet, to the Point of Beginning, containing an area of 30.77 acres, more or less.

That the accompanying plat is a true delineation of said measurements drawn to a scale of 100 feet to the inch. That all dimensions are in feet and decimals and that each lot and block bears its own number designation. That the boundary of the plat is shown with a heavy solid line with dashed lines being shown for orientation purposes only.

WITNESS MY HAND AND SEAL this 21st day of April, 1999
FOR THE FIRM OF M.C. SCHAFF AND ASSOCIATES, INC.

Kelly A. Beatty, Nebraska Registered Land Surveyor, L.S. 476

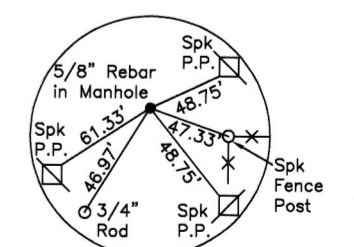

East Quarter Corner
Section 24, T22N, R55W
Existing 5/8" Rebar in Manhole

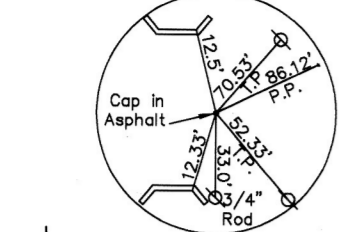

North 1/4 Corner
Section 24, T22N, R55W
Existing Cap in Asphalt

United Telephone Company of the West,
20' x 20' Utility Easement

Additional 20' R.O.W.
for Erwin Avenue

BLOCK 1

8.61 Acres ±

BLOCK 2
8.74 Acres ±

BLOCK 5
5.01 Acres \pm

BLOCK 3
3.61 Acres ±

BLOCK 4
3.14 Acres ±

NOTE: Block 4 shall be used and dedicated only for use as Public Storm Water Retention Area and Public Utility Easement

Center of Section
Section 24, T22N, R55W
Existing Spike in Asphalt

QUINDT
COMMERCIAL
TRACTS

SE Corner
SW 1/4 NE 1/4
Section 24, T22N, R55W
-Computed Location only,
did not Set Corner

3647

BLOCKS ONE THROUGH FIVE
SYKES ADDITION
SCOTTSBLUFF, NEBRASKA
SHEET 2 OF 3

OWNER'S STATEMENT

We, the undersigned being the owners of that part of the Northwest Quarter of the Northeast Quarter of Section 24, Township 22 North, Range 55 West of the 6th P.M., Scotts Bluff County, Nebraska, as described in the foregoing "Surveyor's Certificate" and shown on the accompanying plat have caused such real estate to be platted as BLOCKS ONE THROUGH FIVE, SYKES ADDITION, AN ADDITION TO THE CITY OF SCOTTSBLUFF, SCOTTS BLUFF COUNTY, NEBRASKA.

That the foregoing plat is made with the free consent and in accordance with the desires of the undersigned owners. We hereby dedicate the streets and utility easements shown on the plat to the use and benefit of the public, and further annex and make such real estate a part of the City of Scottsbluff, Nebraska.

DATED THIS 13th DAY OF May, 19 99.

TWIN CITY DEVELOPMENT

SYKES REALTY, INC.

BY: Rudy Szweczek

BY: Managing Director

ACKNOWLEDGMENT

STATE OF NEBRASKA)
COUNTY OF SCOTTS BLUFF)

Before me, a Notary Public, qualified and acting in said county, personally came Rudy Szweczek, Executive Director, Twin City Development, to me known to be the identical person whose signature is affixed to the foregoing "Owner's Statement" and acknowledged the execution thereof to be his voluntary act and deed and deed of Twin City Development.

WITNESS MY NOTARIAL SEAL THIS 13th DAY OF May, 19 99.

Stephanie Smith
Notary Public

My Commission Expires: Apr 20, 2002

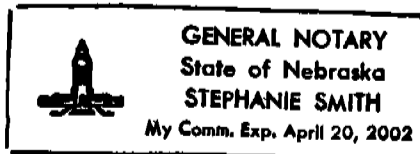

BLOCKS ONE THROUGH FIVE
SYKES ADDITION
SCOTTSBLUFF, NEBRASKA
SHEET 3 OF 3

ACKNOWLEDGMENT

STATE OF NEBRASKA)
COUNTY OF SCOTTS BLUFF)

Before me, a Notary Public, qualified and acting in said county, personally came David P. Keate
Managing Director, Sykes Realty, to me known to be the identical person whose signature is affixed to the
foregoing "Owner's Statement" and acknowledged the execution thereof to be his voluntary act and deed and
deed of Sykes Realty.

WITNESS MY NOTARIAL SEAL THIS 13th DAY OF May, 1999.

Stephanie Smith
Notary Public

My Commission Expires: April 20, 2002

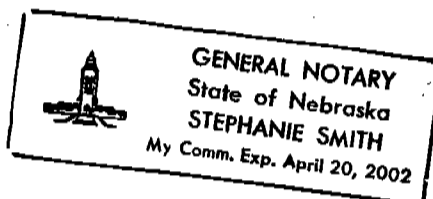

APPROVAL AND ACCEPTANCE

The foregoing plat of BLOCKS ONE THROUGH FIVE, SYKES ADDITION, AN ADDITION TO THE CITY OF
SCOTTSBLUFF, SCOTTS BLUFF COUNTY, NEBRASKA, is hereby approved and accepted by the Mayor and
City Council of the City of Scottsbluff, Scotts Bluff County, Nebraska, by resolution 99-4-7

dated this 26th day of April, 1999.

Mark W. Hunt
Mayor

Attest: Bonnie Otter
City Clerk

