

1612

LOTS 9 through 14, BLOCK 1, and
 LOTS 1 through 6, BLOCK 2
 WESTWOOD ESTATES
 GERING, NEBRASKA
 SHEET 2 OF 3

SURVEYOR'S CERTIFICATE

I, Kelly A. Beatty, a Nebraska Registered Land Surveyor, hereby certify that I have prepared a plat of Lots 9 through 14, Block 1, and Lots 1 through 6, Block 2, Westwood Estates, an Addition to the City of Gering, Scotts Bluff County, Nebraska, situated in the Southwest Quarter of the Southwest Quarter of Section 2, Township 21 North, Range 55 West of the 6th P.M., Scotts Bluff County, Nebraska, more particularly described as follows:

Commencing at the Southeast Corner of the Southwest Quarter of the Southwest Quarter of said Section 2, thence westerly on the South line of Section 2, a distance of 110.00 feet, to the Point of Beginning, thence continuing westerly on the South line of Section 2, a distance of 260.00 feet, thence a deflection angle right $89^{\circ}46'02''$, on a line being 370.00 feet West of and parallel with the East line of the Southwest Quarter of the Southwest Quarter of Section 2, a distance of 515.00 feet, thence a deflection angle right $90^{\circ}13'58''$, a distance of 260.00 feet, to the point of intersection with the West Right of Way line of a 20.00 feet alley, as platted in Block 1, Westwood Estates, thence a deflection angle right $89^{\circ}46'02''$, on said West Right of Way line of alley, a distance of 515.00 feet, to the Point of Beginning, containing an area of 3.07 acres, more or less.

That the accompanying plat is a true delineation of such survey drawn to a scale of 100 feet to the inch and that all corners found or set are marked as shown. That all dimensions are in feet and decimals, and that each lot and block has its own number. That the boundary of the plat is shown with a heavy solid line with dashed lines being shown for orientation purposes only.

WITNESS MY HAND AND SEAL this 15th day of February, 19 96.
 FOR THE FIRM OF M. C. SCHAFF AND ASSOCIATES, INC.

Kelly A. Beatty

Kelly A. Beatty, Nebraska Registered Land Surveyor, L. S. 476

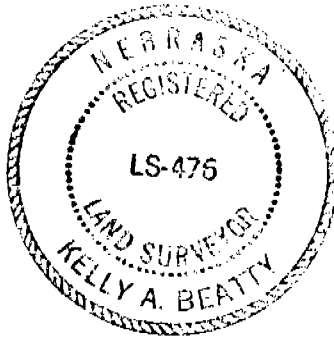

OWNER'S STATEMENT

We, the undersigned, being the owners of that part of the Southwest Quarter of the Southwest Quarter of Section 2, Township 21 North, Range 55 West of the 6th P.M., Scotts Bluff County, Nebraska, as described in the foregoing "Surveyor's Certificate" and shown on the accompanying plat have caused such real estate to be platted as LOTS 9 through 14, BLOCK 1, and LOTS 1 through 6, BLOCK 2, WESTWOOD ESTATES, an Addition to the City of Gering, Scotts Bluff County, Nebraska.

That the foregoing plat is made with the free consent and in accordance with the desires of the undersigned owners. We hereby dedicate the streets, alley and utility easements shown on the plat to the use and benefit of the public.

Dated this 15th day of February, 19 96.

Westwood Development Corporation,
 a Nebraska Corporation

By: *Jon E. Hegwood*
 Jon E. Hegwood, President

1612

LOTS 9 through 14, BLOCK 1, and
LOTS 1 through 6, BLOCK 2
WESTWOOD ESTATES
GERING, NEBRASKA
SHEET 3 OF 3

ACKNOWLEDGEMENT

STATE OF NEBRASKA
COUNTY OF SCOTTS BLUFF

Before me, a Notary Public, qualified and acting in said County, personally came Jon E. Hegwood, President, Westwood Development Corporation, a Nebraska Corporation, to me known to be the identical person whose signature is affixed to the foregoing "Owner's Statement" and acknowledged the execution thereof to be his voluntary act and deed and the voluntary act and deed of the corporation.

WITNESS MY HAND AND NOTARIAL SEAL this 15th day of Feb 1996.

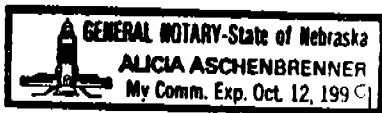

Alicia Aschenbrenner
Notary Public

My Commision Expires: Oct 12, 1999

APPROVAL

The foregoing plat of LOTS 9 through 14, BLOCK 1, and LOTS 1 through 6, BLOCK 2, WESTWOOD ESTATES, an Addition to the City of Gering, Scotts Bluff County, Nebraska, is hereby approved by the Mayor and City Council of the City of Gering, Scotts Bluff County, Nebraska, by resolution duly passed this 25th day of March, 19 96.

Douglas C. Leafgreen
Mayor Douglas C. Leafgreen

Attest: Pamela K. Richter
City Clerk Pamela K. Richter

