

**LOTS 1 THROUGH 5, BLOCK 1  
PORTAL ADDITION  
GERING, NEBRASKA**

An Addition in the Southwest Quarter of  
Section 1, Township 21 North, Range 55 West  
of the 6th P.M., Scotts Bluff County, Nebraska

Entered in Numerical Index and Filed for Record in the Register of Deeds Office of said County of Scotts Bluff, State of Nebraska,  
this 16 day of February A. D., 1976, at 1:55 o'clock P. M. Recorded in Book 209 of *Records*  
Page 163, thereof. Fee \$ 23.00  
*Mary Jo Kellie* Register of Deeds

929

LOTS 1 THROUGH 5, BLOCK 1  
 PORTAL ADDITION  
 GERING, NEBRASKA  
 SHEET 2 OF 4

## SURVEYOR'S CERTIFICATE

I, Kelly A. Beatty, a Nebraska Registered Land Surveyor, hereby certify that I have surveyed and prepared a plat of LOTS 1 THROUGH 5, BLOCK 1, PORTAL ADDITION, an Addition to the City of Gering, Nebraska, situated in the Southwest Quarter of Section 1, Township 21 North, Range 55 West of the 6th P.M., Scotts Bluff County, Nebraska, more particularly described as follows:

Beginning at the Southeast Corner of Lot 3A, Block 2, a Replat of Lots 1,2 and 3, Block 2, Pappas Second Addition, to the City of Gering, Nebraska, thence easterly on the easterly extension of the South line of Lot 3A, on a bearing of N 89°54'38"E, a distance of 20.00 feet, thence bearing N 00°05'26"W, on a line being 20.00 feet East of and parallel with the East line of Lot 3A, and northerly extension thereof, a distance of 364.80 feet, thence bearing S 89°54'38"W, on a line being 160.00 feet North of and parallel with the North Right of Way line of "L" Street, as platted, a distance of 400.00 feet, to a point being 20.00 feet East of the East line of a tract of land as described in Deed Book 186, Page 397, Scotts Bluff County, Nebraska, Register of Deeds Office, thence bearing N 00°05'26"W, on a line being 20.00 feet East of and parallel with said tract of land, a distance of 44.73 feet, thence bearing S 89°58'41"W, on a line being 20.00 feet North of and parallel with the North line of said described tract, a distance of 72.09 feet, to the point of intersection with the East line of Tax Lot 5C, thence bearing S 00°09'08"W, on the East line of said Tax Lot 5C, a distance of 20.00 feet, to the point of intersection with the North line of previously described tract of land, as recorded in Deed Book 186, Page 397, thence bearing N 89°58'41"E, on the North line of said tract of land, a distance of 52.17 feet, to the Northeast Corner of said tract of land, thence southerly on the East line of said tract of land, bearing S 00°05'26"E, a distance of 184.75 feet, to the point of intersection with the North Right of Way line of "L" Street, thence easterly on said North Right of Way line of "L" Street, bearing N 89°54'38"E, a distance of 400.00 feet, to the point of intersection with the northerly extension of the East line of Lot 3A, Block 2, a Replat of Lots 1,2 and 3, Block 2, Pappas Second Addition, thence southerly on said extension line and East line of Lot 3A, Block 2, Pappas Second Addition, bearing S 00°05'26"E, a distance of 204.80 feet, to the Point of Beginning, containing an area of 1.68 acres, more or less.

That the accompanying plat is a true delineation of such survey drawn to a scale of 60 feet to the inch. That all dimensions are in feet and decimals, that each lot has its own number. That the boundary of the plat is shown with a heavy solid line with dashed lines being shown for orientation purposes only.

WITNESS MY HAND AND SEAL this 9<sup>th</sup> day of February, 1996.  
 FOR THE FIRM OF M. C. SCHAFF AND ASSOCIATES, INC.

*Kelly A. Beatty*

Kelly A. Beatty, Nebraska Registered Land Surveyor, L. S. 476

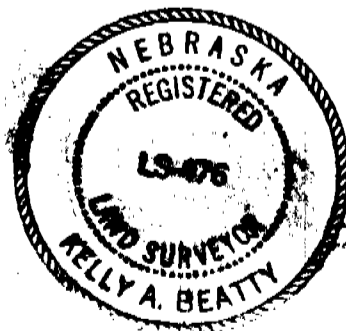

929

LOTS 1 THROUGH 5, BLOCK 1  
PORTAL ADDITION  
GERING, NEBRASKA  
SHEET 3 OF 4

OWNER'S STATEMENT

We, the undersigned, being the owners of that part of the Southwest Quarter of Section 1, Township 21 North, Range 55 West of the 6th P.M., Scotts Bluff County, Nebraska, as described in the foregoing "Surveyor's Certificate" and shown on the accompanying plat have caused such real estate to be platted as LOTS 1 THROUGH 5, BLOCK 1, PORTAL ADDITION, an Addition to the City of Gering, Scotts Bluff County, Nebraska.

That the foregoing plat is made with the free consent and in accordance with the desires of the undersigned owners. We hereby dedicate the street Right of Way, alleys and easements shown on the plat to the use and benefit of the public.

Dated this 12<sup>th</sup> day of February, 19 96.

Portal Enterprises, Inc.,  
A Nebraska Corporation

City of Gering, Nebraska,  
A Nebraska Corporation

By: Darrell D Bentley  
Darrell Bentley, President



By: Douglas C Leafgreen  
Douglas C. Leafgreen, Mayor

ACKNOWLEDGEMENT

STATE OF NEBRASKA }  
COUNTY OF SCOTTS BLUFF }

Before me, a Notary Public, qualified and acting in said County, personally came Darrell Bentley, President of Portal Enterprises, Inc., a Nebraska Corporation, to me known to be the identical person whose signature is affixed to the foregoing "Owner's Statement" and acknowledged the execution thereof to his voluntary act and deed and the voluntary act and deed of Portal Enterprises Inc.

WITNESS MY HAND AND NOTARIAL SEAL this 12<sup>th</sup> day of Feb 19 96.

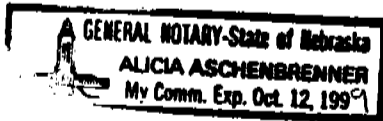

Alicia Aschenbrenner  
Notary Public

My Commision Expires: Oct 12, 1999

LOTS 1 THROUGH 5, BLOCK 1  
PORTAL ADDITION  
GERING, NEBRASKA  
SHEET 4 OF 4

929

ACKNOWLEDGEMENT

STATE OF NEBRASKA }  
COUNTY OF SCOTTS BLUFF }

Before me, a Notary Public, qualified and acting in said County, personally came Douglas C. Leafgreen, Mayor of the City of Gering, Nebraska, a Nebraska Corporation, on behalf of the Corporation, to me known to be the identical person whose signature is affixed to the foregoing "Owner's Statement" and acknowledged the execution thereof to be his voluntary act and deed and the voluntary act and deed of the Corporation.

WITNESS MY HAND AND NOTARIAL SEAL this 14<sup>th</sup> day of February 1996.

Peggy A. Abernethy  
Notary Public

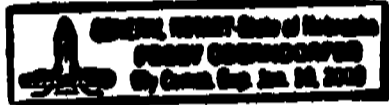

My Commision Expires: \_\_\_\_\_

APPROVAL AND ACCEPTANCE

The foregoing plat of LOTS 1 THROUGH 5, BLOCK 1, PORTAL ADDITION, an Addition to the City of Gering, Scotts Bluff County, Nebraska, is hereby approved by the Mayor and City Council, City of Gering, Scotts Bluff County, Nebraska, by resolution duly passed this 12<sup>th</sup> day of February, 1996.

Douglas C. Leafgreen  
Mayor, Douglas C. Leafgreen

Attest: Pamela K. Richter  
Pamela K. Richter

