



2022-4626

RECORDED
SCOTTS BLUFF COUNTY, NE

COMPUTER ca
PICTURED ca
IMAGED _____

Date 9-7-22 Time 9:22AM

Inst. 2022 4626
Jean A. Bauer

REGISTER OF DEEDS

NUM PAGES 3
DCCOUNTY _____ FD _____ CHG _____ RET _____
FEE 22.00 FD _____ CHG - RET _____
TOTAL 22.00
BNDT _____
RET Bldg: Joming Bice Mabin

THIS PAGE INCLUDED FOR INDEXING PURPOSES

FINAL PLAT

TRACT 1, VISAGE SUBDIVISION, A SUBDIVISION OF A PART OF THE EAST HALF OF THE NORTHWEST QUARTER OF SECTION 24, TOWNSHIP 23 NORTH, RANGE 55 WEST OF THE 6TH P.M., SCOTTS BLUFF COUNTY, NEBRASKA.

SURVEYOR'S CERTIFICATE:

I, SCOTT M. BOSSE, NEBRASKA REGISTERED LAND SURVEYOR NUMBER 603, DO HEREBY CERTIFY THAT I HAVE SURVEYED THE TRACT OF LAND DESCRIBED IN THE LEGAL DESCRIPTION AND PREPARED THE PLAT FOR TRACT 1, VISAGE SUBDIVISION, A SUBDIVISION OF A PART OF THE EAST HALF OF THE NORTHWEST QUARTER OF SECTION 24, TOWNSHIP 23 NORTH, RANGE 55 WEST OF THE 6TH P.M., SCOTTS BLUFF COUNTY, NEBRASKA, AS SHOWN ON THE ACCOMPANYING DRAWING; THAT THE ACCOMPANYING DRAWING IS A CORRECT DELINEATION OF SAID SURVEY DRAWN TO A SCALE OF 200 FEET TO THE INCH; THAT SAID SURVEY AND DRAWING WAS CONDUCTED BY ME OR UNDER MY DIRECT SUPERVISION; THAT THE DISTANCES ARE GROUND DISTANCES GIVEN IN FEET AND DECIMALS OF A FOOT; AND THE MONUMENTS WERE FOUND OR SET AS INDICATED AND THE BOUNDARY IS DEPICTED BY A THICKENED SOLID LINE.

WITNESS MY HAND AND SEAL this 10th day of July, 2022.

Scott M. Bosse
NEBRASKA REGISTERED LAND SURVEYOR NUMBER 603

OWNER'S CERTIFICATE:

I BEING THE UNDERSIGNED, BEING THE OWNER OF THAT PART OF THE EAST HALF OF THE NORTHWEST QUARTER OF SECTION 24, TOWNSHIP 23 NORTH, RANGE 55 WEST OF THE 6TH P.M., SCOTTS BLUFF COUNTY, NEBRASKA, AS DESCRIBED IN THE FOREGOING "SURVEYOR'S CERTIFICATE" AND SHOWN ON THE ACCOMPANYING PLAT, HAVE CAUSED SAID REAL ESTATE TO BE SURVEYED AND PLATTED AS: TRACT 1, VISAGE SUBDIVISION, A SUBDIVISION OF A PART OF THE EAST HALF OF THE NORTHWEST QUARTER OF SECTION 24, TOWNSHIP 23 NORTH, RANGE 55 WEST OF THE 6TH P.M., SCOTTS BLUFF COUNTY, NEBRASKA.

THE FOREGOING, TRACT 1, VISAGE SUBDIVISION, IS MADE WITH THE FREE CONSENT AND IN ACCORDANCE WITH THE UNDERSIGNED OWNER.

Terry Jessen
TERRY JESSEN, TERRY'S LEGACY LLC

APPROVAL AND ACCEPTANCE:

THE ACCOMPANYING PLAT WAS APPROVED BY THE PLANNING COMMISSION OF SCOTTS BLUFF COUNTY, NEBRASKA,

THIS 9th DAY OF August, 2022.

THE ACCOMPANYING PLAT WAS APPROVED BY THE COUNTY COMMISSIONERS OF SCOTTS BLUFF COUNTY, NEBRASKA,

THIS 15th DAY OF August, 2022.

Terry Jessen
CHAIRMAN

ATTEST: Bobbie Dendy
COUNTY CLERK

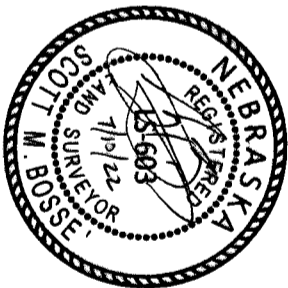

ACKNOWLEDGMENT:

STATE OF NEBRASKA)
COUNTY OF SCOTTS BLUFF)

BEFORE ME, A NOTARY PUBLIC, QUALIFIED AND ACTING IN SAID COUNTY, PERSONALLY CAME TERRY JESSEN, FOR TERRY'S LEGACY LLC, TO ME KNOWN TO BE THE IDENTICAL PERSON WHOSE SIGNATURE IS AFFIXED TO THE FOREGOING "OWNER'S STATEMENT" AND ACKNOWLEDGED THE EXECUTION THEREOF TO BE THEIR VOLUNTARY ACT AND DEED.

WITNESS MY NOTORIAL SEAL THIS 11th DAY OF August, 2022.

Bobbie Dendy
NOTARY PUBLIC

MY COMMISSION EXPIRES: November 20, 2023



Date: 7-10-2022
Time: 4:15 PM
Drawn By: S.M.
Revised:

ACCUSTAR SURVEYING
 30601 COUNTY ROAD 17 MITCHELL, NE 68357
 PHONE: (308) 823-0197 CELL: (308) 631-0737

PROJECT:
 VISAGE SUBDIVISION 24-23-55
 TERRY JESSEN
 SCOTTSBLUFF, NEBRASKA

SHEET
 2 OF 2