



2007-5152

NUM PAGES 1
 DOC TAX _____ PD _____ CHG _____ RET _____
 FEES 6.00 PD _____ CHG ✓ RET _____
 TOTAL _____
 REC'D Kelly Beatty
 RET M.C. Schaff & Assoc., Inc
818 Beltline Hwy E, SCB

AFFIDAVIT

Inst. 2007 - 5152

18A

I, Kelly A. Beatty, a Nebraska Registered Land Surveyor, being first duly sworn on this oath, states as follows:

1. AFFIANT is employed by M.C. Schaff & Associates, Inc., Scottsbluff, Nebraska, and represents them in this affidavit.
2. On or about February 22, 2007, a subdivision plat of Block One, Meyer Subdivision, situated in the Southeast Quarter of Section 28, Township 23 North, Range 53 West of the 6th P.M., Scotts Bluff County, Nebraska, was prepared and signed by Kelly A. Beatty, L.S. 476, and subsequently approved by the County on May 21, 2007. It was then recorded on July 16, 2007 in Instrument 2007-4201.
3. After recording of the Subdivision, it was discovered that a previous plat named Block One, Meyer Subdivision situated in Section 8, Township 20 North, Range 55 West of the 6th P.M., Scotts Bluff County, Nebraska, had been approved by the County and recorded in Deed Book 220, page 238 in Scotts Bluff County Register of Deed's office, dated September 22, 1999.
4. So as to avoid confusion between the two Block One, Meyer Subdivisions in different Sections, the recently approved Block One, Meyer Subdivision in Section 28, Township 23 North, Range 53 West of the 6th P.M., Scottsbluff County Nebraska, recorded in Instrument 2007-4201, shall now be officially known as "Block One **Jake Meyer Subdivision**", situated in the Southeast Quarter of Section 28, Township 23 North, Range 54 West of the 6th P.M., Scotts Bluff County, Nebraska.
5. This Affidavit shall be indexed against the Final Plat as recorded in Instrument 2007-4201 to change the name as reference on this plat from "Block One, Meyer Subdivision in Southeast Quarter of Section 28, Township 23 North, Range 54 West of the 6th P.M., Scotts Bluff County, to "Block One, **Jake Meyer Subdivision**.
6. This name change is in concurrence with the wishes the owners of that real estate as recorded in Instrument 2007-4201.

FURTHER AFFIANT SAITH NOT

FOR THE FIRM OF
M.C. SCHAFF & ASSOCIATES, INC.

Kelly A. Beatty, a Nebraska Registered Land Surveyor, L.S. 476

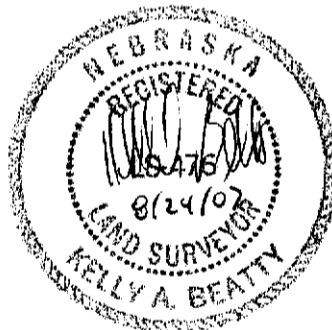

Acknowledgement

State of Nebraska)
)ss
 Scotts Bluff County)

Before me a Notary Public, qualified and acting in said County, came Kelly A. Beatty, whose signature is affixed to the foregoing "Affidavit" before me this 24th day of August, 2007.

Notary Public

My Commission Expires: Oct 12, 2007

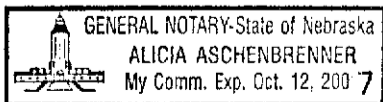

RECORDED
SCOTTS BLUFF COUNTY, NE

Date 8-27-07 Time 1:27pm

NUM. INDEX mj
 COMPUTER m
 PICTURED m
 IMAGED _____

REGISTER OF DEEDS