

PLAT AND DEDICATION

4550

Of part of the West half of 17th Avenue
in the City of Scottsbluff, Nebraska.

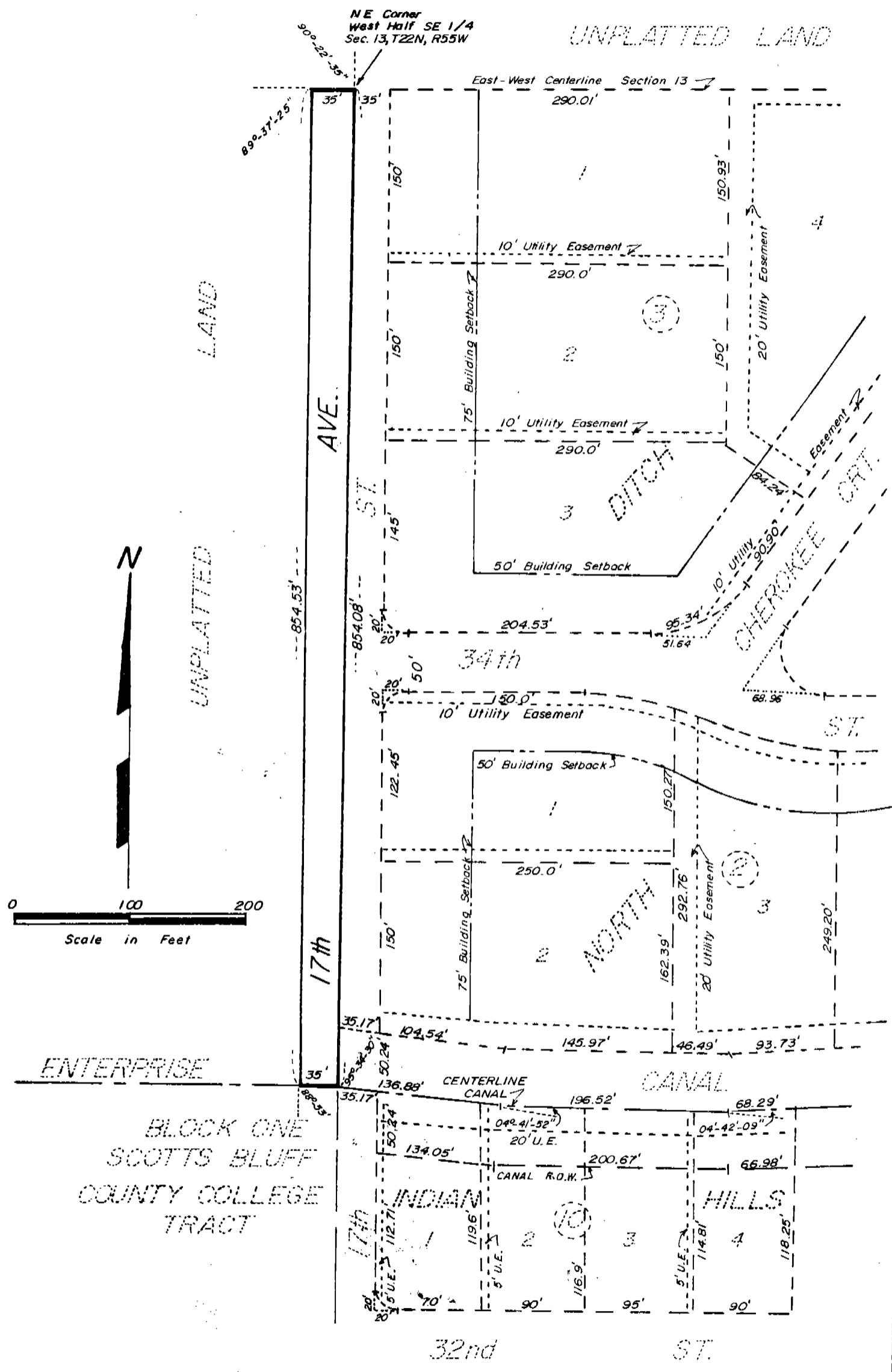

SURVEYOR'S CERTIFICATE

I, Duane E. Stott, a competent surveyor of Scotts Bluff County, Nebraska, hereby certify that I have surveyed and prepared a plat of a tract of land situated in the West Half of the Southeast Quarter of Section 13, Township 22 North, Range 55 West of the 6th P.M., Scotts Bluff County, Nebraska, and that said tract shall be referred to and known as the WEST HALF OF 17th AVENUE in the City of Scottsbluff, Nebraska, the boundary of said tract being more particularly described as follows:

Beginning at the Northeast Corner of the West Half of the Southeast Quarter of said Section 13; thence, Westerly on the North Line of said West Half of the Southeast Quarter, a distance of 35.0 feet; thence, a deflection angle left of 89 degrees 37 minutes 25 seconds, a distance of 854.53 feet to a point on the North Line of Block One, Scotts Bluff County College Tract; thence, a deflection angle left of 88 degrees 53 minutes 00 seconds on the North Line of said Block One, a distance of 35.00 feet to the Northeast Corner of said Block One, such Northeast Corner being on the East Line of the West Half of the Southeast Quarter of Section 13; thence, Northerly on said East Line, a distance of 854.08 feet to the point of beginning, containing an area of 0.69 acres more or less.

That the accompanying plat is a true delineation of such survey, drawn to a scale of 100 feet to the inch and that all corners are marked with 3/4" x 36" reinforcing bars, driven well into the ground.

WITNESS MY HAND AND SEAL this 8th day of August, 19 77.

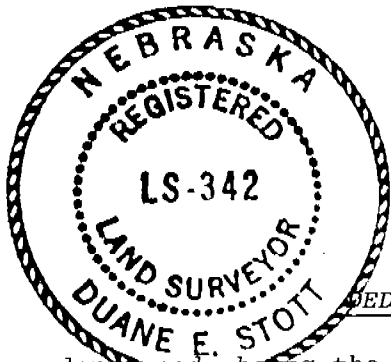

FOR THE FIRM OF M.C. SCHAFF & ASSOCIATES, INC.

Duane E. Stott
Duane E. Stott, Nebraska Registered
Land Surveyor, L.S. 342

DEDICATION AND ANNEXATION

I, the undersigned, being the Owner of that part of the Southeast Quarter of Section 13, Township 22 North, Range 55 West of the 6th P.M., Scotts Bluff County, Nebraska, as shown and described in the foregoing plat and "Surveyor's Certificate", have caused such real estate to be surveyed and platted as the WEST HALF OF 17th AVENUE, a street in the City of Scottsbluff, Nebraska, as shown on the accompanying plat.

We hereby dedicate the WEST HALF OF 17th AVENUE to the use and benefit of the public and further annex and make such real estate a part of the City of Scottsbluff, Nebraska.

Dated this 8th day of August, 19 77.

MAXWELL, INCORPORATED
A Nebraska Corporation

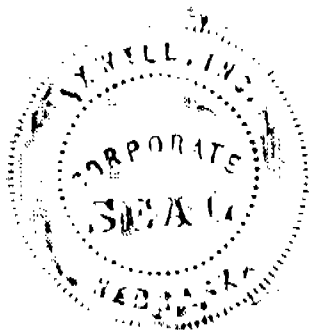

Melvin Maxwell
Melvin L. Maxwell, President

#950
RUBEN AND
A. C. SCHAFF & ASSOCIATES
SCOTTSBLUFF, NEB.

State of Nebraska, Scotts Bluff County ss.
Entered in Numerical Index and filed for
record the 16th day of August, 19 77
at 8:40 o'clock A. M., and recorded in
Book 155 of Deeds
on page 276
Mary J. Ellis
Register of Deeds
By _____ Deputy

ACKNOWLEDGEMENT

STATE OF NEBRASKA)
SCOTTS BLUFF COUNTY) SS

Before me, a Notary Public, qualified and acting in said County, personally came Melvin L. Maxwell, President of Maxwell, Inc., a Nebraska Corporation, to me known to be the identical person and President of such Corporation, who signed the foregoing "Dedication and Annexation" and acknowledged the execution thereof to be his voluntary act and deed and the voluntary act and deed of such corporation, and that his Corporate Seal was thereto affixed by its authority.

WITNESS MY HAND AND NOTARIAL SEAL this 8th day of AUGUST, 1977.

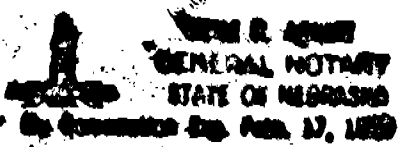

Wm. R. Ament
Notary Public

My Commission Expires: FEBR. 17, 1980

APPROVAL AND ACCEPTANCE

The foregoing plat of the WEST HALF OF 17th AVENUE, a Street in the City of Scottsbluff, Nebraska, hereby approved by the Mayor and City Council of the City of Scottsbluff, Nebraska, by resolution duly passed this 7th day of August, 1977.

Ronald E. Querman
Mayor

ATTEST:

Dorothy [Signature]
City Clerk

