

# RISOR SUBDIVISION

OF TRACT TWELVE (12), GOOS TRACTS  
AN ADDITION OF THE CITY OF SCOTTSBLUFF, NEBRASKA

2195

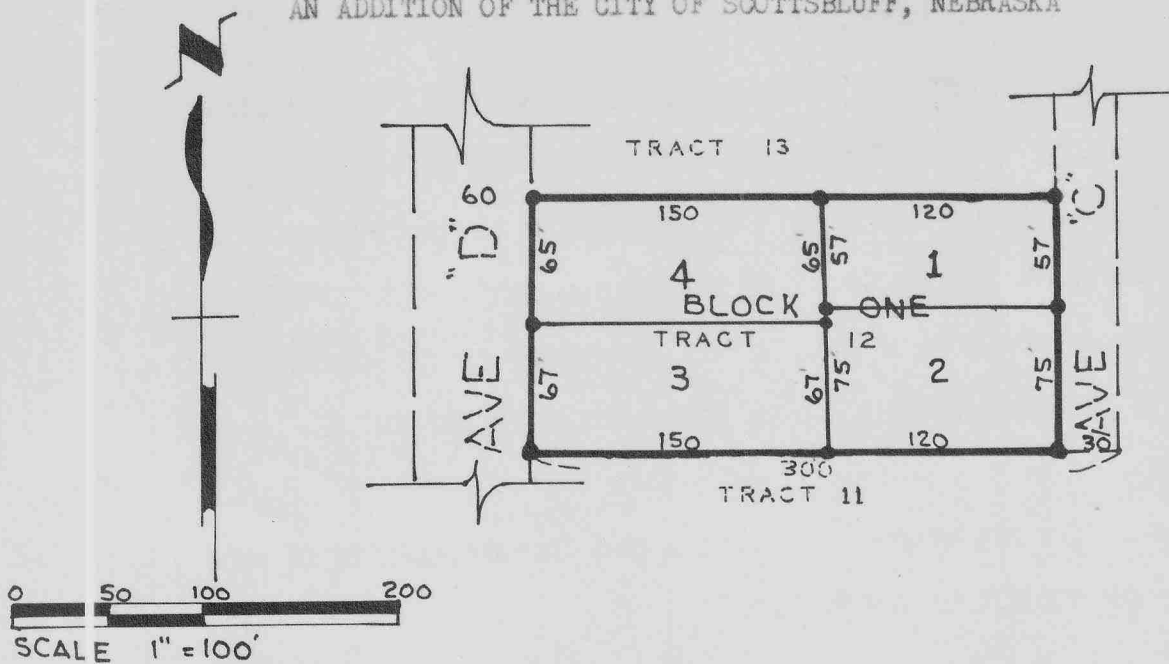

SURVEYOR'S CERTIFICATE

I, E.Y. GRUPE, A COMPETENT SURVEYOR OF SCOTTSBLUFF COUNTY, NEBRASKA, DO HEREBY CERTIFY THAT A SURVEY WAS COMPLETED UNDER MY DIRECTION OF "RISOR SUBDIVISION" OF TRACT TWELVE (12) GOOS TRACTS, AN ADDITION OF THE CITY OF SCOTTSBLUFF, NEBRASKA, AND SUCH LAND HAS BEEN SUBDIVIDED AS LOTS 1, 2, 3 & 4, BLOCK 1, OF SUCH SUBDIVISION.

THAT THE ACCOMPANYING PLAT IS A CORRECT DELINEATION OF SUCH SURVEY DRAWN TO A SCALE OF 100 FEET TO ONE INCH, WITH ALL DIMENSIONS SHOWN THEREON IN FEET AND DECIMALS.

THAT 5/8" x 36" IRON RODS ARE DRIVEN WELL INTO THE GROUND AT ALL CORNERS OF SUCH BLOCK 1.

THAT ALL INTERIOR LOT CORNERS ARE MARKED WITH 5/8" x 18" IRON RODS.

THAT THE BOUNDARY OF THE SUBDIVISION IS MARKED WITH A HEAVY SOLID LINE AND ALL BROKEN LINES INDICATE LANDS AND RIGHTS OF WAYS ADJOINING BUT NOT A PART OF THIS SUBDIVISION.

WITNESS MY HAND AND SEAL THIS 4<sup>th</sup> DAY OF JUNE 1969.

*E. Y. Grupe*  
E.Y. GRUPE, SCOTTSBLUFF, NEBRASKA  
NEBRASKA REGISTERED LAND SURVEYOR  
L.S. 69



DEDICATION

I, THE UNDERSIGNED, BEING THE OWNER OF TRACT TWELVE (12), GOOS TRACTS, AN ADDITION IN THE CITY OF SCOTTSBLUFF, NEBRASKA, HAVE CAUSED SUCH LAND TO BE SURVEYED, SUBDIVIDED AND PLATTED AS "RISOR SUBDIVISION" OF TRACT TWELVE (12) GOOS TRACTS, AS SHOWN ON THE ACCOMPANYING PLAT AND SURVEYOR'S CERTIFICATE.

THE FOREGOING SUBDIVISION OF REAL ESTATE AS APPEARS ON THE ACCOMPANYING PLAT IS MADE WITH THE FREE CONSENT AND IN ACCORDANCE WITH THE DESIRES OF THE UNDERSIGNED OWNER.

I, HEREBY DEDICATE THE AVENUES DESIGNATED UPON AND REFERRED TO IN SUCH PLAT TO THE USE AND BENEFIT OF THE PUBLIC.

DATED THIS 11<sup>th</sup> DAY OF June 1969.

Anne Risor  
ANNE RISOR

ACKNOWLEDGEMENT

STATE OF NEBRASKA )  
COUNTY OF SCOTTSBLUFF )

BEFORE ME, A NOTARY PUBLIC QUALIFIED FOR SUCH COUNTY, PERSONALLY CAME ANNE RISOR, A SINGLE PERSON; KNOWN TO ME TO BE THE IDENTICAL PERSON WHO SIGNED THE FOREGOING INSTRUMENT, AND ACKNOWLEDGED THE EXECUTION THEREOF TO BE HER VOLUNTARY ACT AND DEED.

WITNESS MY HAND AND NOTARIAL SEAL ON June 11, 1969.

Ginger A. Towne  
NOTARY PUBLIC

MY COMMISSION EXPIRES: Sept. 10, 1971

APPROVAL AND ACCEPTANCE

THE ACCOMPANYING PLAT AND DEDICATION APPROVED AND ACCEPTED BY THE MAYOR AND CITY COUNCIL OF THE CITY OF SCOTTSBLUFF, NEBRASKA BY RESOLUTION DULY PASSED THIS 28<sup>th</sup> DAY OF July, 1969.

L. G. Thomas  
MAYOR

ATTEST  
W.L. Ferguson  
CITY CLERK-W.L. FERGUSON

2197

NUMERICAL  
GENERAL  
TAX REG.  
PICTURED

SURVIVORSHIP WARRANTY DEED

Form 4.1

.....  
.....  
.....  
.....

— to —

STATE OF NEBRASKA,

County of *Scotts Bluff*

Filed for record

*July 30*, 19*69*, at  
*2:25 P.* M., and recorded

in Deed Record

*130*, page *197*.  
*Mary Jo E. Elnor*  
County Clerk or  
Register of Deeds.

*James M. Somjad*  
Deputy

HAVE THIS DEED RECORDED

*175* Glen E. James  
*1st* 1608- Ave. S  
*Deb*

Felton & Wolf Co., Lincoln, Nebr.

2195

NUMERICAL  
GENERAL  
TAX REG.  
PICTURED

STATE OF NEBRASKA } ss.  
SCOTTS BLUFF COUNTY }

Entered on Numerical Index and filed for

record the *30* day of *July*

19 *69*, at *11:45* o'clock *A.* M., and

recorded in Book *130* of

*Deeds*

Records on Page *195*

*Mary Jo Elnor*  
REGISTER OF DEEDS

By *James M. Somjad* Deputy  
*50*  
*38*