

DEED RECORD.

Note: See Book 133 Page 421-Sub-Div. of Lot 6 Block 3 First Addition.

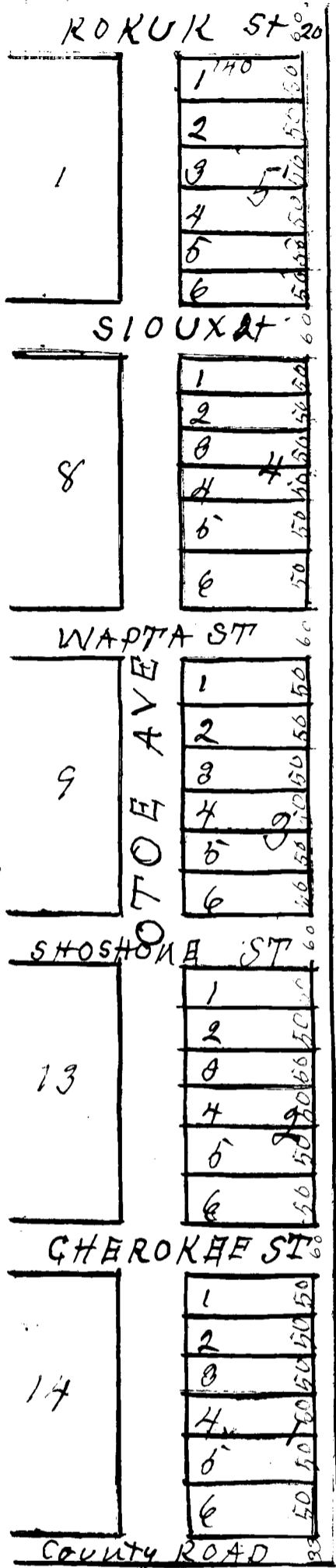

FIRST ADDITION TO SCOTTSBLUFF.

SCOTTS BLUFF COUNTY, NEBRASKA.

I hereby Certify that on the 22, day of December, 1904, I surveyed First Addition to Scottsbluff, situated on a part of the E.2, of the S.E. 4, of Sec 23, T. 22, N. R. 55, of the 6th P.M. which is clearly shown by reference to the original town, The Streets in the Addition running East and West, being extensions of those of the same name in the original town, Burr Oak stakes are driven well into the ground at the front corner of each lot, The annexed Plat is a correct delineation of said Addition, drawn to a Scale of 180 feet to an inch, together with part of Blocks 1, 8, 9, and 14. in dotted lines of the original town, The Dimension of Lots and width of streets, avenues and alleys, are indicated in feet, by Red figures on the Plat, Each Lot and Block has its own Number.

Witness my hand this 29th day of March 1905.

Anselmo B. Smith,
Surveyor.

This Certifies that the Lincoln Land Company, a Corporation organized and existing under the Laws of the State of Nebraska, who own in fee that part of the East half of the South East Quarter (E.2, S.E.4,) of Section Twenty-three (23), in Township Twenty two, (22), North of Range Fifty-five (55), West of the Sixth Principal meridian, on which First Addition of Scottsbluff is located, as shown by this Plat and the foregoing Surveyors Certificate, :

That said Owners has caused said Land to be surveyed and Platted, as said First addition to Scottsbluff, as shown by said Plat and Surveyor's Certificate, . That the Streets, Avenues, and Aleys, indicated on said plat, are mentioned in said Surveyors Certificate, are hereby dedicated to the Public use.

IN Testimony Whereof, the Lincoln Land Company, has caused this instrument to be signed by its President, Countersigned by its Secretary, and the Corporate Seal of the Company to be hereunto affixed, this Seventh day of April A.D. 1905. Executed in Duplicate.

Countersigned, Lincoln Land Company. SEAL.
A.B. Minor? Secretary. By
Witness Signature of President, C.H. Morrill, President.

James F. Boyce.

State of Nebraska)
Lancaster County,) SS. BE IT KNOWN, That on the seventh day of April, A.D. 1905, before me, a Notary Public, in and for said County, Personally appeared C.H. Morrill President, of the Lincoln Land Company, who is personally known to me to be the identical person whose name is subscribed to the foregoing instrument as said President, and then and there acknowledge said instrument and the execution thereof, to be his voluntary act and deed, and the voluntary act and deed of said Company.

SEAL. Witness my hand and Notarial Seal, the day Last above written.

James F. Boyce
Notary public.

My Commission Expires December 8, 1909.

Entered on Numerical Index and filed for record the 14, day of April A.D. 1905 at 9 0' Clock A.M. and Recorded in Book k. of Deeds at Page 368.

Jas McKinley County Clerk.
By M. Bristol Deputy.