

# DEED RECORD X, SCOTTS BLUFF COUNTY

KLOPF & BARTLEY CO., PRINTING, STATIONERY, COUNTY AND SCHOOL SUPPLIES, OMAHA

Scottsbluff Realty Company  
to  
The Public

STATE OF NEBRASKA, Scotts Bluff County, ss.  
Entered on Numerical Index and filed for record the 12 day of Aug. 1916, at 8 o'clock A.M. and recorded in Book X of Deeds on Page 486.  
J. H. Ferguson  
Co. Clerk.

THIRD LINCOLN HEIGHTS ADDITION  
to  
SCOTTSBLUFF  
Scotts Bluff Co. Nebraska

I hereby certify that on the 13th day of June I surveyed Third Lincoln Heights Addition to Scottsbluff situated on a part of Sec. 23 T 22 N R 55 W, described as follows: Beginning at a point 539' West of a stone at the center of Sec 23, T 22N, R 55W, thence West 382', thence North 754<sup>0</sup>', thence East 382', thence South 754<sup>0</sup>' to the point of beginning, that the above plat is a correct delineation of said survey drawn to a scale of 100' feet to an inch, Naponee Ave. is parallel with Iroquois Ave in the First Lincoln Heights Addition, East and West Streets are extensions of those of the same name in First and Second Lincoln Heights Additions. Oak stakes are driven well into the ground at the front corners of each lot. The width of streets and alleys and dimensions of lots are indicated in feet and decimals. Each lot and block bears its own number.  
Witness my hand this 19th day of June, A.D. 1916.

A. L. Selzer,  
Surveyor.

10<sup>1</sup>/<sub>2</sub> Int. Rev.  
Stamp A.L.S.  
6/13/16.

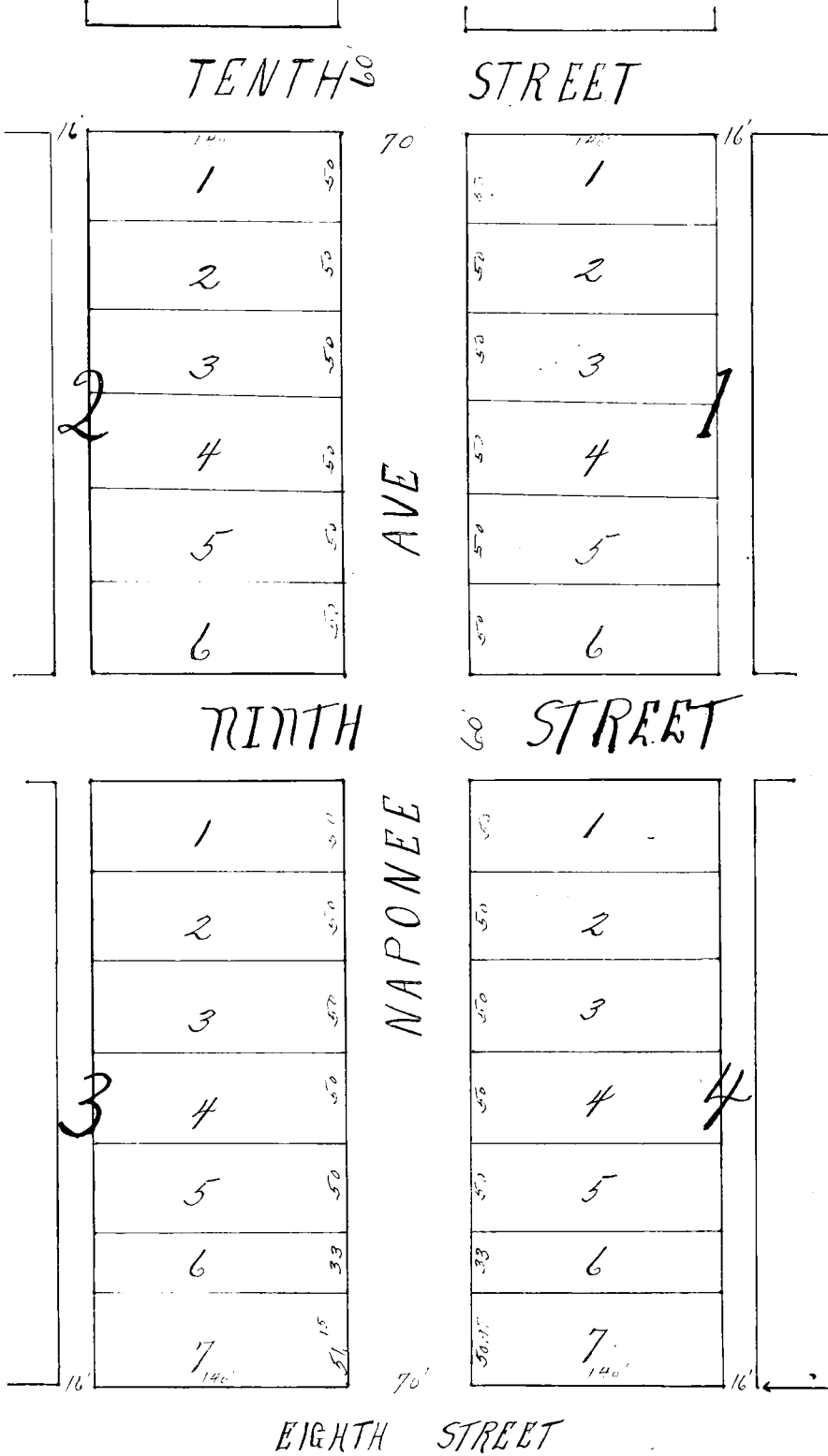

This certifies that the Scottsbluff Realty Company, a Corporation, duly organized and existing under the laws of the State of Nebraska, is the owner in fee of that part of section numbered Twenty three (23) in Township numbered twenty two (22) North of Range numbered Fifty five (55) West of the Sixth Principal Meridian described as follows: Beginning at a point 539 feet West of a stone at the center of Sec. 23 T 22 N. R 55 W., thence West 382 feet, thence North 754<sup>0</sup> feet thence East 382 feet thence South 754<sup>0</sup> feet to the point of beginning on which the Third Lincoln Heights Addition to the city of Scottsbluff is located as shown by the foregoing plat and surveyors certificate, that the said owner has caused said land to be surveyed and platted as the Third Lincoln Heights Addition to Scottsbluff as shown by said plat and surveyor's certificate that the streets indicated on said plat and mentioned in said Surveyors certificate are hereby dedicated to the Public Use.

In testimony whereof, the Scottsbluff Realty Company has caused this instrument to be signed by the President, counter signed by its secretary, and the Corporate Seal of said company to be hereunto affixed this 10th day of August, A. D. 1916.



SCOTTSBLUFF REALTY COMPANY  
By Charles A. Morrill President  
Countersigned  
R. H. Thompson Secretary  
Witness to signature of President  
J. L. Witters.

STATE OF NEBRASKA,  
SCOTTS BLUFF COUNTY. } ss.

On this 10th day of August, 1916, before me, the undersigned, a notary public in and for said county, personally came Charles A. Morrill, President of the Scottsbluff Realty Company, to me personally known to be the president and the identical person whose name is affixed to the above instrument and acknowledged the execution thereof to be his voluntary act and deed as such officer and the voluntary act and deed of the Scottsbluff Realty Company for the purposes therein expressed.

WITNESS my hand and notarial seal the day and year last above written.

J. L. Witters  
Notary Public.

My commission expires October 15, 1921.

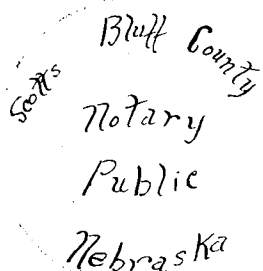

#####