

DEED RECORD N.

43880—Kemp & Bartlett Co., Printing, Lithographing, Stationery, Omaha

CHAUTAUQUA ADDITION No. 2

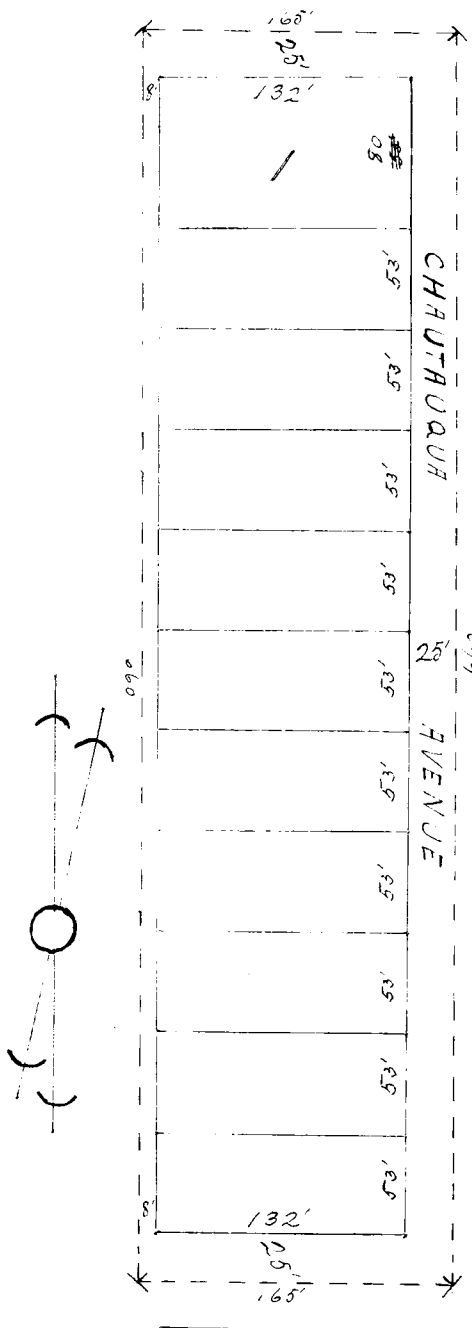

State of Nebraska County of Scotts Bluff, SS
 Entered on numerical index and filed for record the
 21st day of Sept, 1909 at 2 o'clock P.M. and
 recorded in Book N of deeds, on page 336.
 A. H. McHenry, County Clerk.

I, A. B. McCoskey, do hereby certify that the above
 plat correctly represents CHAUTAUQUA ADDITION No. 2
 being a part of the SW $\frac{1}{4}$ of the SW $\frac{1}{4}$ of Sec. 24, T. 22,
 N. R. 55 W. more particularly described as follows

Beginning at a point 1320 ft North (va 15° 15')
 and 825 ft East (va 15° 58') ~~ft~~ from the SW corner
 of said sec. thence E. (va 15° 58') 165 ft, thence
 S. va 15° 15' 660 ft, thence W. (va 15° 58') 165 ft.
 thence N. (va 15° 15') 660 ft to the place of
 beginning, containing 2 $\frac{1}{2}$ acres; that the above plat
 was made from notes taken during an actual survey
 made by me on the 26th day of July 1907; that pine
 stakes 2 inches square were driven well into the
 ground at the front corners of each lot; that each
 lot bears its own number and the width of the land
 given for streets and alley is as indicated on the
 plat.

A. B. McCoskey, Surveyor.

KNOW ALL MEN BY THESE PRESENTS:

That We, William L. Simmons and Alpha N. Simmons, husband and wife, of Scottsbluff,
 Nebraska, being the owners in fee simple of the tract of land described as follows: Beginning
 at a point 1320 feet North (var 15 15') and 825 feet East (var 15 58') (from the SW corner of
 SW $\frac{1}{4}$ of Section 24, Tp. 22, R. 55, West, 6th P.M., thence running East (Var 15 58') ~~from the~~
~~SW corner of the SW $\frac{1}{4}$ of section 24, Tp. 22, R. 55 West 6th P.M., thence running East (var 15 58')~~
 165 feet, thence South (var 15 15') 660 feet, thence west (var 15 58') 165 feet thence North
 (var 15 58') 660 feet to the place of beginning, have caused the same to be surveyed and
 platted as "CHAUTAUQUA ADDITION NO 2" as shown by the accompanying plat hereto attached, and
 made a part of the deed, same bearing the certificate of A. B. McCoskey, Surveyor, and we
 hereby dedicate to the public the streets and alleys and other public grounds as shown by
 said plat. Dated this Sept. 16, 1909.

William L. Simmons

Alpha N. Simmons.

The State of Nebraska,)
) : SS.
 County of Scotts Bluff.)

SCOTTS BLUFF COUNTY
 NOTARIAL SEAL
 NEBRASKA.

On this Sept. 16, 1909, personally appeared before me, the
 undersigned, a notary public duly commissioned and qualified
 for and residing in said County, the above named William L.
 Simmons and Alpha N. Simmons, husband and wife, to me personally

known and they severally acknowledged the execution of the above instrument to be their
 free act and deed for the purposes therein expressed.

Witness my hand and seal the date last above written.

F. S. McCaffree,
 Notary Public.

My Commission expires May 22, 1914.

#####