

DEED RECORD :

LOGAN'S ADDITION TO MITCHELL.

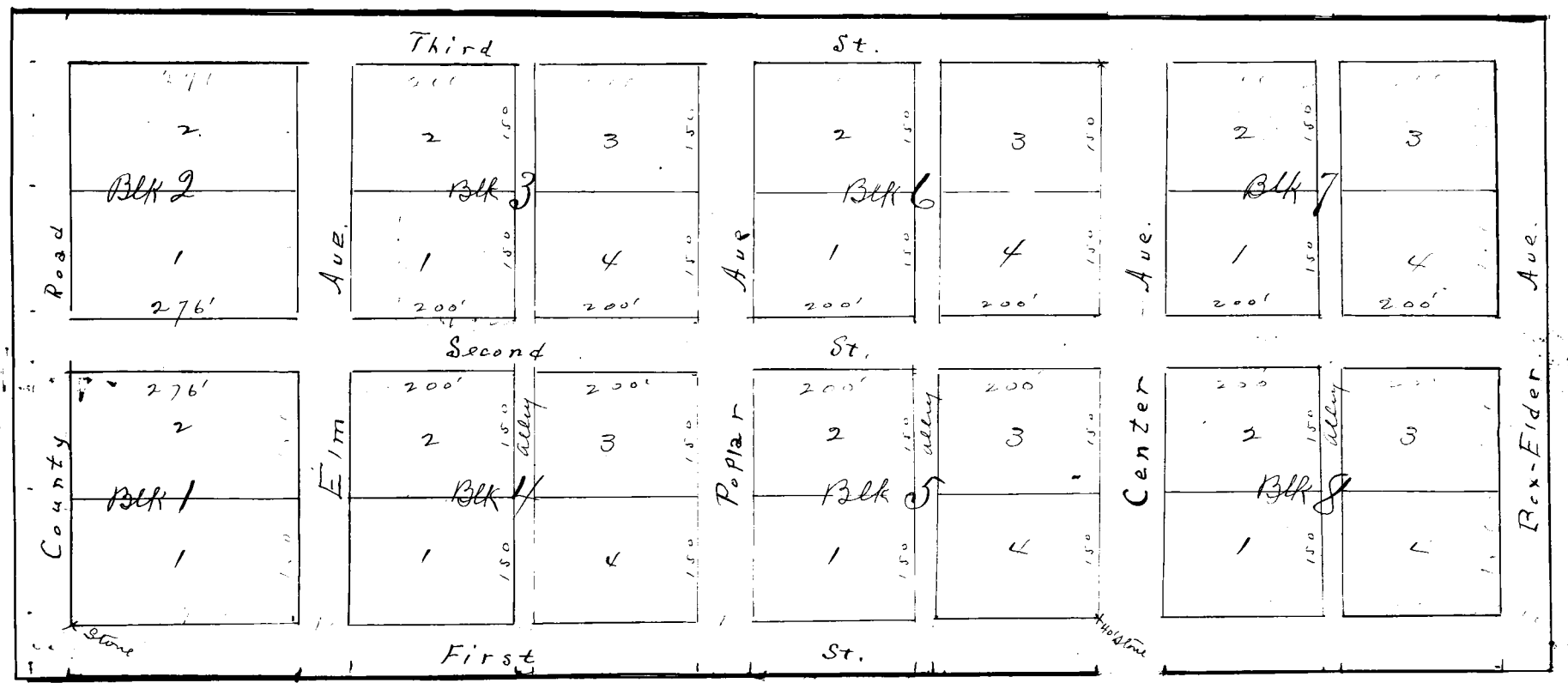

Frank L. Logan,
to
The Public Use.

State of Nebraska County of Scotts Bluff, SS.
Entered on Numerical Index and filed for record the 2nd
day of May 1906 at 3 o'clock P.M. and recorded in Book L
of Deeds, page 95.

County Clerk.

I hereby certify that on the 6th day of April 1906 I surveyed Logan's Addition to the town of Mitchell, Nebraska, said Addition is represented by the above plat and is a part of the SW $\frac{1}{4}$ of Section 22 Tp. 23 N. R. 56 W. more particularly described as follows: Beginning at a point 630 feet North and 33 feet East of the corner of Sections 21, 22, & 28, Tp. 23 N. R. 56 W. Thence East (Var. 15° 15') 1796 feet; Thence North (Var. 15° 20') 780 ft; Thence West (Var. 15° 15') 1796 ft; Thence South (Var. 15° 20') 780 ft; to the place of beginning containing 32.159 acres. The above plat is a correct delineation of said survey drawn to a scale of 160 ft. to an inch. The streets and alleys are laid out parallel with and at right angles to the Section line between Sections 22 & 27 Tp. 23 R/ 56, and Center Avenue, in width and direction is a continuation of center avenue in the original town of Mitchell. Pine stakes are driven well into the ground at the front corners of each lot and stones planted 1 $\frac{1}{2}$ feet deep in the ground at the places indicated. The width of streets, avenues and alleys and the deminstitutions of the lots and other distances are as indicated in figures on the plat. Each lot and block bears its own number.

WITNESS my hand this 25th day of April 1906. A. B. McCoskey, Surveyor.

KNOW ALL MEN BY THESE PRESENTS:

That I, Frank L. Logan, a widower, am the present owner of the South West quarter (SW $\frac{1}{4}$) of Section twenty-two (22) in Township twenty-three (23) North, of Range Fifty-six (56) West of the 6th Principal Meridian, on which Logan's Addition to the town of Mitchell is located as shown by the foregoing plat and Surveyor's Certificate: That I have caused the said land to be surveyed and platted as "Logan's Addition to Mitchell." as shown by the plat and Surveyor's Certificate; that the streets, avenues and alleys indicated on said plat and described in said Surveyor's Certificate are hereby dedicated to the public use.

IN WITNESS WHEREOF I have hereunto set my hand this 1st day of May, 1906.
In presence of
G. E. Mark. Frank L. Logan.

State of Nebraska,)
:SS:
Scotts Bluff County.)

BE IT KNOWN, that on the 1st day of May A.D. 1906 before me the undersigned, a Notary Public in and for said County, personally appeared Frank L. Logan to me known to be the identical person whose name is affixed to the above instrument as grantor and he acknowledged the execution of said instrument to be his voluntary act and deed.

WITNESS my hand and Notarial Seal the day last aforesaid.
(SEAL) My Commission expires Dec? 31, 1909. G. E. Mark, Notary Public.

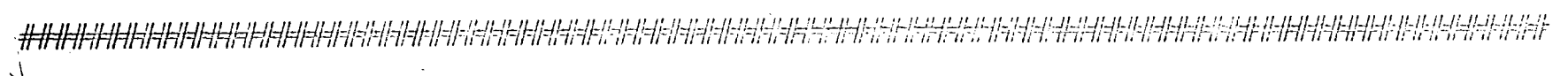

PLAINTIFF'S EXHIBIT 709
R.M.M.