

11 12 Sec.
14 13 Sec.

DATED
I, The undersigned City Engineer For The City Of Scottsbluff, Nebraska, Do Hereby
Certify: That This Plat is A Correct Delineation Of Sections Marked AW (Alley Way)
A RePlat of The First Addition and of The Original Fairview Cemetery, Scotts
Bluff Co. Nebraska, That all of the Lots Designated By AW, On Said Plat
Are Within The Boundaries of Said Plat and The First Addition Of Said
Cemetery.

86	97	110	172	185	196	209	221	234	245	258	300	328	349	373	382	395
AW	AW	AW	AW	AW	AW	AW	AW	AW	AW	AW	AW	AW	AW	AW	AW	AW
87	98	111	174	186	197	210	223	235	248	259	301	329	349A	374	383	396
AW	AW	AW	AW	AW	AW	AW	AW	AW	AW	AW	AW	AW	AW	AW	AW	AW
88	99	112	175	187	200	211	224	236	249	292	302	330	350	375	384	397
AW	AW	AW	AW	AW	AW	AW	AW	AW	AW	AW	AW	AW	AW	AW	AW	AW
89	102	113	176	188	201	214	225	237	250	293	303	331	351	376	385	398
AW	AW	AW	AW	AW	AW	AW	AW	AW	AW	AW	AW	AW	AW	AW	AW	AW

CITY ENGINEER

20	26	33	41	48	56	63	71	78	90	103	166	177	189	202	215	226	238	251	294	304	332	352	377	389	416	
AW	AW	AW	AW	AW	AW	AW	AW	AW	AW	AW	AW	AW	AW	AW	AW	AW	AW	AW	AW	AW	AW	AW	AW	AW	AW	AW
21	27	34	42	49	57	64	72	79	91	104	167	178	191	203	216	227	240	253	295	305	333	354	377A	390	417	
AW	AW	AW	AW	AW	AW	AW	AW	AW	AW	AW	AW	AW	AW	AW	AW	AW	AW	AW	AW	AW	AW	AW	AW	AW	AW	AW
22	29	35	43	50	59	65	73	80	93	105	168	179	192	204	217	228	241	254	296	320	344	355	378	391	418	
AW	AW	AW	AW	AW	AW	AW	AW	AW	AW	AW	AW	AW	AW	AW	AW	AW	AW	AW	AW	AW	AW	AW	AW	AW	AW	AW
23	30	38	44	51	60	68	74	81	94	106	169	180	193	205	218	229	242	255	297	321	345	356	379	392	419	
AW	AW	AW	AW	AW	AW	AW	AW	AW	AW	AW	AW	AW	AW	AW	AW	AW	AW	AW	AW	AW	AW	AW	AW	AW	AW	AW
24	31	39	46	54	61	69	76	82	95	107	170	181	194	206	219	232	243	256	298	322	347	357	380	393A	420	
AW	AW	AW	AW	AW	AW	AW	AW	AW	AW	AW	AW	AW	AW	AW	AW	AW	AW	AW	AW	AW	AW	AW	AW	AW	AW	AW
25	32	40	47	55	62	70	77	83	96	108	171	184	195	208	220	233	244	257	299	323	348	372	381	405	421	
AW	AW	AW	AW	AW	AW	AW	AW	AW	AW	AW	AW	AW	AW	AW	AW	AW	AW	AW	AW	AW	AW	AW	AW	AW	AW	AW

ACCEPTANCE
This Plat approved and
accepted by the Mayor and City Council
of the City of Scottsbluff, Nebraska by
Ordinance 104 duly passed on this 5 day
of April, 1955

Attest *Blanche Williams*
City Clerk



REPLAT OF SECTION 8 AN ADDITION TO THE

SCALE
1" = 20'

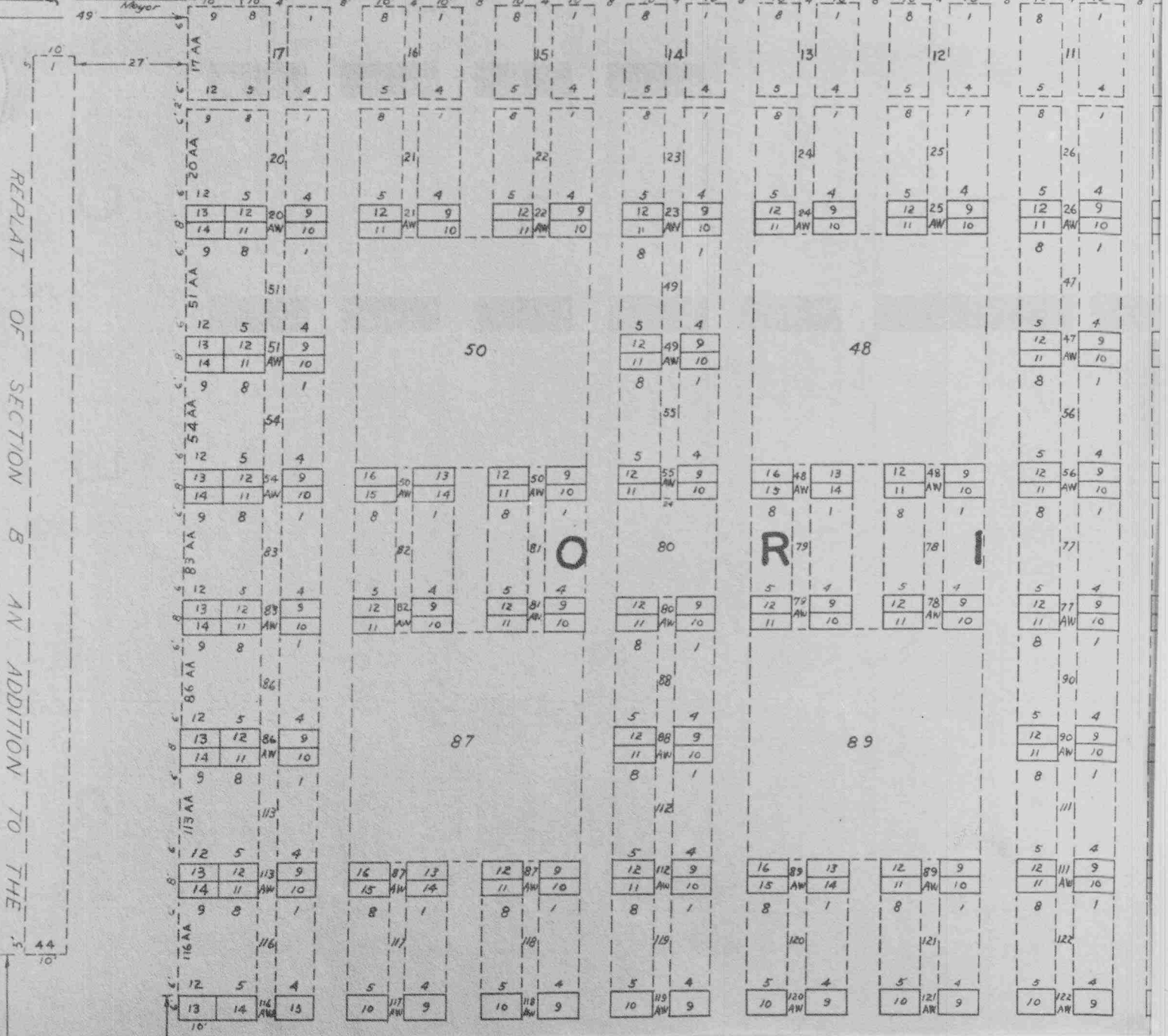

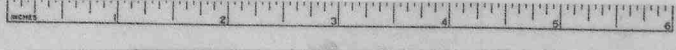

County Road

RE-PLAT ORIGINAL FAIRVIEW CEMETERY AND FIRST ADDITION ALLEYWAYS SCOTTSBLUFF, NEBRASKA

422	432	457	481	505	513	116	127
AW	AW	AW	AW	AW	AW	AW	AW
423	433	458	482	506	514	117	128
AW	AW	AW	AW	AW	AW	AW	AW
425	434	458A	483	507	515	118	129
AW	AW	AW	AW	AW	AW	AW	AW
426	435	459	484	508	516	119	130
AW	AW	AW	AW	AW	AW	AW	AW
427	436	460	485	509	517	120	131
AW	AW	AW	AW	AW	AW	AW	AW
428	437	461	486	510	518	121	
AW	AW	AW	AW	AW	AW	AW	
429	438	463	487	510D		122	
AW	AW	AW	AW	AW		AW	
430	453	464	488	511D		123	
AW	AW	AW	AW	AW		AW	
430A	454	465	489	511		125	
AW	AW	AW	AW	AW		AW	
431	456	466	490	512		126	
AW	AW	AW	AW	AW		AW	

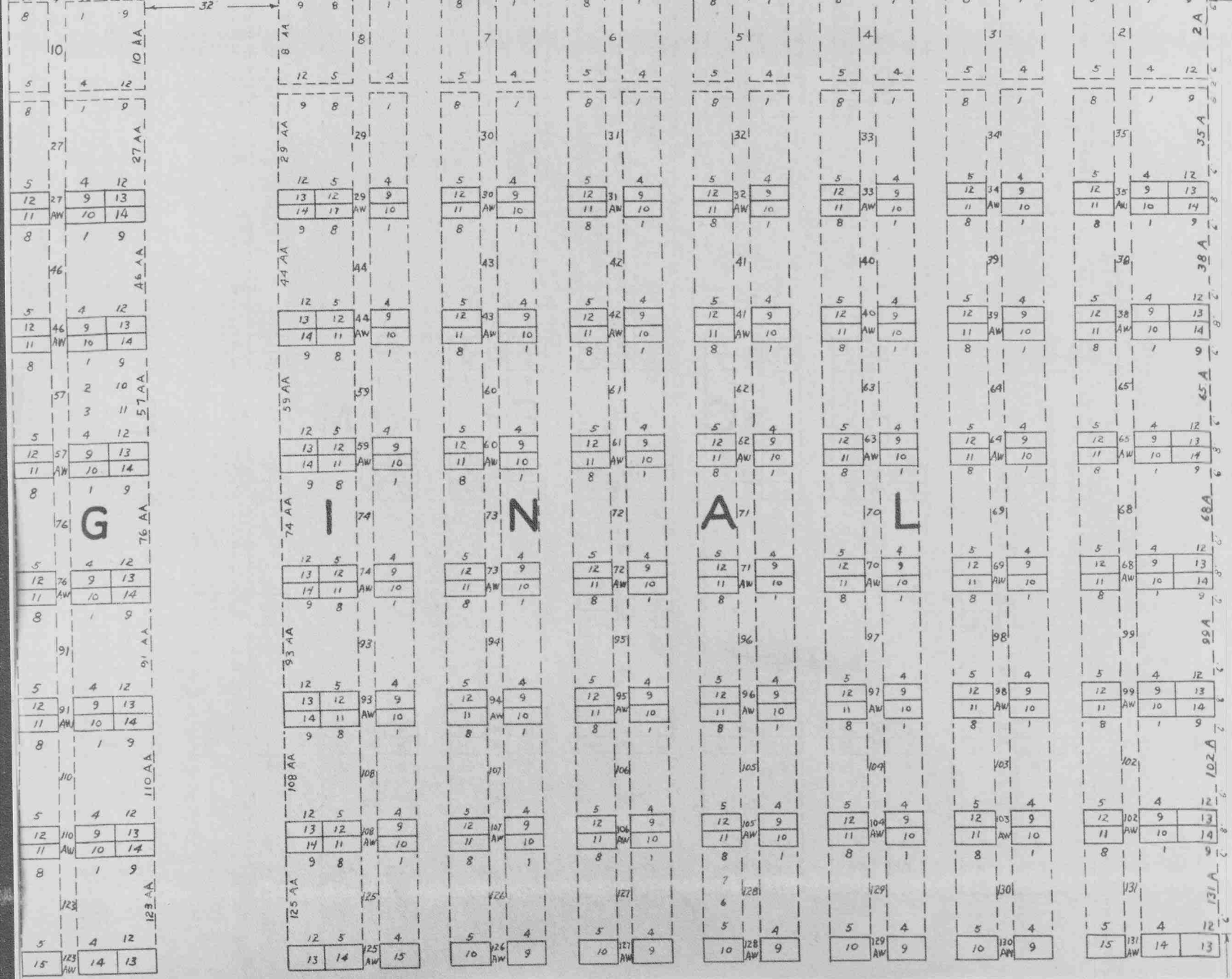

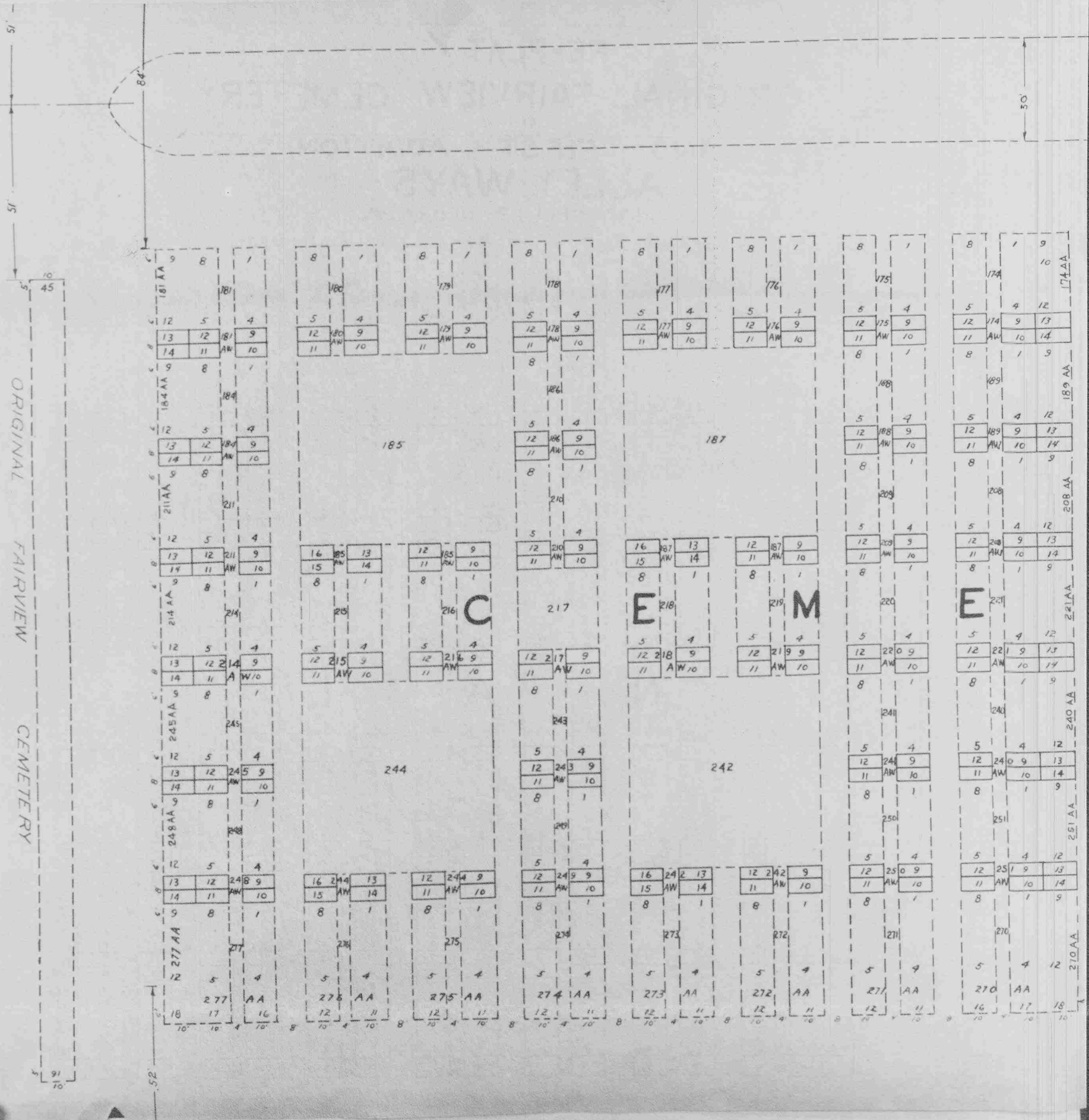

ORIGINAL FAIRVIEW CEMETERY

181 AA	8	1
12 5 4		
13 12 18 9		
14 11 AW 10		
184 AA	8	1
12 5 4		
13 12 18 9		
14 11 AW 10		
211 AA	8	1
12 5 4		
13 12 21 9		
14 11 AW 10		
214 AA	8	1
12 5 4		
13 12 21 9		
14 11 AW 10		
245 AA	8	1
12 5 4		
13 12 24 9		
14 11 AW 10		
248 AA	8	1
12 5 4		
13 12 24 9		
14 11 AW 10		
277 AA	8	1
12 5 4		
13 12 27 9		
14 11 AW 10		

180	8	1
5 4		
12 18 9		
11 AW 10		
179	8	1
5 4		
12 17 9		
11 AW 10		
185	8	1
5 4		
12 17 9		
11 AW 10		
186	8	1
5 4		
12 17 9		
11 AW 10		
210	8	1
5 4		
12 21 9		
11 AW 10		
187	8	1
5 4		
12 21 9		
11 AW 10		
216 C	8	1
16 13		
15 AW 14		
12 13 9		
11 AW 10		
215	8	1
5 4		
12 21 9		
11 AW 10		
216	8	1
5 4		
12 21 9		
11 AW 10		
244	8	1
5 4		
12 24 9		
11 AW 10		
243	8	1
5 4		
12 24 9		
11 AW 10		
274 AA	8	1
16 13		
15 AW 14		
12 13 9		
11 AW 10		
275 AA	8	1
5 4		
12 27 9		
11 AW 10		

178	8	1
5 4		
12 17 9		
11 AW 10		
177	8	1
5 4		
12 17 9		
11 AW 10		
176	8	1
5 4		
12 17 9		
11 AW 10		
175	8	1
5 4		
12 17 9		
11 AW 10		
189 AA	8	1
5 4		
12 18 9		
11 AW 10		
209	8	1
5 4		
12 20 9		
11 AW 10		
208	8	1
5 4		
12 20 9		
11 AW 10		
217	8	1
12 21 9		
11 AW 10		
218	8	1
5 4		
12 21 9		
11 AW 10		
219	8	1
5 4		
12 21 9		
11 AW 10		
241	8	1
5 4		
12 24 9		
11 AW 10		
242	8	1
5 4		
12 24 9		
11 AW 10		
250	8	1
5 4		
12 25 9		
11 AW 10		
271	8	1
5 4		
12 27 9		
11 AW 10		

174	8	1
5 4		
12 17 9		
11 AW 10		
174	8	1
5 4		
12 17 9		
11 AW 10		
174	8	1
5 4		
12 17 9		
11 AW 10		
174	8	1
5 4		
12 17 9		
11 AW 10		
174	8	1
5 4		
12 17 9		
11 AW 10		
174	8	1
5 4		
12 17 9		
11 AW 10		
174	8	1
5 4		
12 17 9		
11 AW 10		
174	8	1
5 4		
12 17 9		
11 AW 10		
174	8	1
5 4		
12 17 9		
11 AW 10		
174	8	1
5 4		
12 17 9		
11 AW 10		

174	8	1
5 4		
12 17 9		
11 AW 10		
174	8	1
5 4		
12 17 9		
11 AW 10		
174	8	1
5 4		
12 17 9		
11 AW 10		
174	8	1
5 4		
12 17 9		
11 AW 10		
174	8	1
5 4		
12 17 9		
11 AW 10		
174	8	1
5 4		
12 17 9		
11 AW 10		
174	8	1
5 4		
12 17 9		
11 AW 10		
174	8	1
5 4		
12 17 9		
11 AW 10		
174	8	1
5 4		
12 17 9		
11 AW 10		
174	8	1
5 4		
12 17 9		
11 AW 10		

174	8	1
5 4		
12 17 9		
11 AW 10		
174	8	1
5 4		
12 17 9		
11 AW 10		
174	8	1
5 4		
12 17 9		
11 AW 10		
174	8	1
5 4		
12 17 9		
11 AW 10		
174	8	1
5 4		
12 17 9		
11 AW 10		
174	8	1
5 4		
12 17 9		
11 AW 10		
174	8	1
5 4		
12 17 9		
11 AW 10		
174	8	1
5 4		
12 17 9		
11 AW 10		
174	8	1
5 4		
12 17 9		
11 AW 10		

174	8	1
5 4		
12 17 9		
11 AW 10		
174	8	1
5 4		
12 17 9		
11 AW 10		
174	8	1
5 4		
12 17 9		
11 AW 10		
174	8	1
5 4		
12 17 9		
11 AW 10		
174	8	1
5 4		
12 17 9		
11 AW 10		
174	8	1
5 4		
12 17 9		
11 AW 10		
174	8	1
5 4		
12 17 9		
11 AW 10		
174	8	1
5 4		
12 17 9		
11 AW 10		
174	8	1
5 4		
12 17 9		
11 AW 10		

15
15
10
45
5
91
52

10

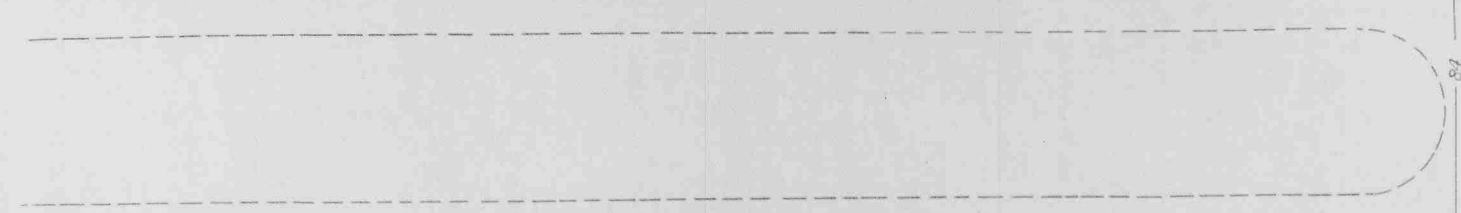

172 AA	9 8 1	172	8 1	171	8 1	170	169	168	167	166	166 A
	12 5 4		5 4		5 4		5 4		5 4		5 4 12
	13 12 17 9		12 17 9		12 17 9		12 16 9		12 16 9		12 16 9 13
	14 11 AW 10		11 AW 10		11 AW 10		11 AW 10		11 AW 10		11 AW 10 14
	9 8 1		8 1		8 1		8 1		8 1		8 1 9
191 AA	9 8 1	191	8 1	192	8 1	193	194	195	196	197	197 A
	12 5 4		5 4		5 4		5 4		5 4		5 4 12
	13 12 19 9		12 19 9		12 19 9		12 19 9		12 19 9		12 19 9 13
	14 11 AW 10		11 AW 10		11 AW 10		11 AW 10		11 AW 10		11 AW 10 14
	9 8 1		8 1		8 1		8 1		8 1		8 1 9
206 AA	9 8 1	206	8 1	207	8 1	208	209	210	211	212	212 A
	12 5 4		5 4		5 4		5 4		5 4		5 4 12
	13 12 20 9		12 20 9		12 20 9		12 20 9		12 20 9		12 20 9 13
	14 11 AW 10		11 AW 10		11 AW 10		11 AW 10		11 AW 10		11 AW 10 14
	9 8 1		8 1		8 1		8 1		8 1		8 1 9
223 AA	10 11 12 13 14 15 16 17 18	223	10 11 12 13 14 15 16 17 18	224	10 11 12 13 14 15 16 17 18	225	226	227	228	229	229 A
	12 5 4		5 4		5 4		5 4		5 4		5 4 12
	13 12 22 9		12 22 9		12 22 9		12 22 9		12 22 9		12 22 9 13
	14 11 AW 10		11 AW 10		11 AW 10		11 AW 10		11 AW 10		11 AW 10 14
	9 8 1		8 1		8 1		8 1		8 1		8 1 9
238 AA	10 11 12 13 14 15 16 17 18	238	10 11 12 13 14 15 16 17 18	239	10 11 12 13 14 15 16 17 18	240	241	242	243	244	244 A
	12 5 4		5 4		5 4		5 4		5 4		5 4 12
	13 12 23 9		12 23 9		12 23 9		12 23 9		12 23 9		12 23 9 13
	14 11 AW 10		11 AW 10		11 AW 10		11 AW 10		11 AW 10		11 AW 10 14
	9 8 1		8 1		8 1		8 1		8 1		8 1 9
253 AA	10 11 12 13 14 15 16 17 18	253	10 11 12 13 14 15 16 17 18	254	10 11 12 13 14 15 16 17 18	255	256	257	258	259	259 A
	12 5 4		5 4		5 4		5 4		5 4		5 4 12
	13 12 25 9		12 25 9		12 25 9		12 25 9		12 25 9		12 25 9 13
	14 11 AW 10		11 AW 10		11 AW 10		11 AW 10		11 AW 10		11 AW 10 14
	9 8 1		8 1		8 1		8 1		8 1		8 1 9
268 AA	10 11 12 13 14 15 16 17 18	268	10 11 12 13 14 15 16 17 18	269	10 11 12 13 14 15 16 17 18	270	271	272	273	274	274 A
	12 5 4		5 4		5 4		5 4		5 4		5 4 12
	13 14 15 16 17 18		10 11 12 13 14 15 16 17 18		10 11 12 13 14 15 16 17 18		10 11 12 13 14 15 16 17 18		10 11 12 13 14 15 16 17 18		10 11 12 13 14 15 16 17 18
	18		12		12		12		12		12



32'

42'

52

REPLAT OF SECTION B AN ADDITION TO FIRST





