

# DEED RECORD, No. 6

Yorick Nichols & wife

STATE OF NEBRASKA, Scotts Bluff County, ss.

to  
The Public

Entered on Numerical Index and filed for record  
the 13 day of September 1919, at 8:30 o'clock  
A.M. and recorded in book 6 of Deeds on Page 307.  
R. G. Neeley, Register of Deeds.

### NICHOLS ADDITION TO HENRY NEBRASKA

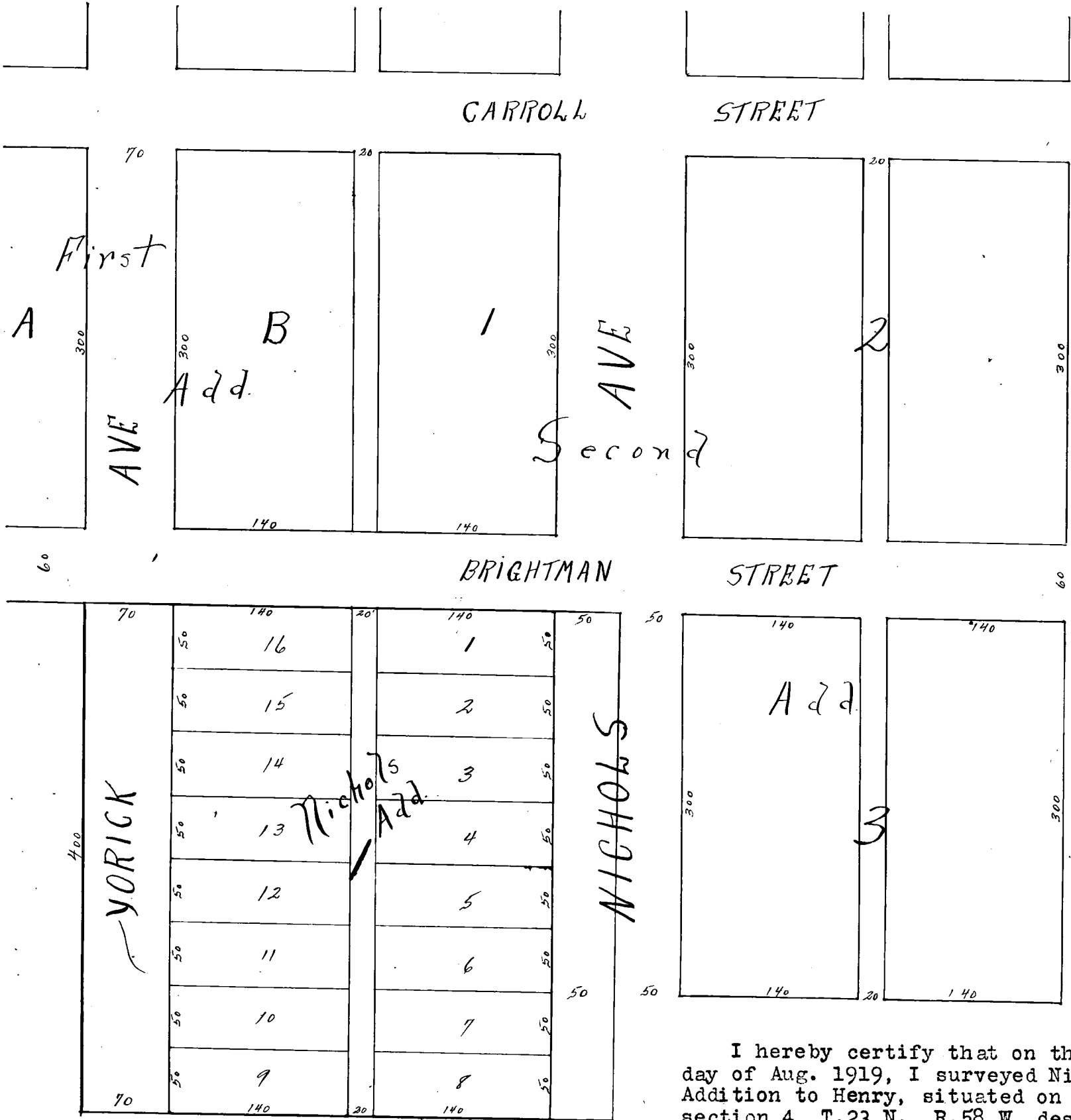

I hereby certify that on the 2nd day of Aug. 1919, I surveyed Nichols Addition to Henry, situated on a part of section 4, T.23 N., R.58 W. described as follows: Beginning at a point 60 feet

South of the southwest corner of B, First Addition to Henry, on a line obtained by producing the west line of said block B, thence East 350 feet, thence South 400 feet, thence West 420 feet, thence North 400 feet, thence East 70 feet to the point of beginning; that the above plat is a correct delineation of said survey drawn to a scale of 100 feet to an inch. 2"x2" oak stakes are driven well into the ground at front corners of each lot. The width of streets and alley and the dimensions of the lots are indicated on the plat in feet and decimals. Each lot and block bears its own number. Yorick and Nichols avenues are extensions of streets of the same name in First and Second additions.

Witness my hand this 13th day of August, 1919.

A. L. Selzer, Surveyor.

This certifies that Yorick Nichols and Maude Nichols, husband and wife are owners of that part of section 4, T23 N., R58 W. of the 6th P.M. described as follows: Beginning at a point 60 feet South of Southwest corner of Block B, First Addition to Henry, thence East 350 feet thence South 400 feet, thence West 420 feet, thence North 400 feet, thence East 70 feet to point of beginning; on which Nichols Addition to Henry is located as shown by foregoing plat and surveyor's certificate; that the above and foregoing subdivision of that part of Section 4, town 23, R 58, as appears on this plat and described above is made with the free consent and in accordance with the desire of the undersigned owners and proprietors. The streets and alley shown on the above plat and described in the surveyor's certificate are hereby dedicated to the public's use.

IN TESTIMONY WHEREOF we have hereunto set our hands this 19th day of August A.D. 1919  
Witness: G T Holloway  
Maude Nichols  
Yorick Nichols

STATE OF NEBRASKA, )  
Scotts Bluff County, )ss.

On this 19th day of Aug. 1919, before me, the undersigned a Notary Public in and for said County, personally came Yorick Nichols and Maude Nichols, husband and wife, to me personally known to be the identical persons whose names are affixed to the above instrument and acknowledged the execution thereof to be their voluntary act and deed for the purpose therein expressed.

WITNESS my hand and seal the day and year last above written  
My commission expires March 21-1925.  
G. T. Holloway  
Notary Public.

