

**LOT 3, BLOCK 1,
CIVIC CENTER SUBDIVISION
TO THE CITY OF GERING, NEBRASKA**

2612

A REPLAT OF THE WEST 40 FEET OF LOT 3, ALL OF LOTS 4 and 5, THE SOUTH 75 FEET OF LOT 7, and ALL OF LOTS 8, 9, 10, BLOCK 5, ORIGINAL TOWN ADDITION TO THE CITY OF GERING, SCOTTS BLUFF COUNTY, NEBRASKA, and INCLUDING THAT PORTION OF THE VACATED ALLEY BETWEEN LOT 2, BLOCK 1, CIVIC CENTER SUBDIVISION TO THE CITY OF GERING, NEBRASKA, and THE EASTERLY LINE OF LOT 6, BLOCK 5, ORIGINAL TOWN ADDITION TO THE CITY OF GERING, NEBRASKA

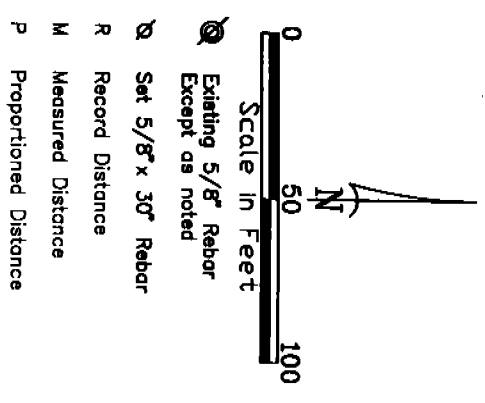

- ⊗ Existing 5/8" Rebar Except as noted
- ⊗ Set 5/8" x 30" Rebar
- R Record Distance
- M Measured Distance
- P Proportioned Distance

PLAT B
 City of Gering
 25.00'

State of Nebraska, Scotts Bluff County ss.
 Entered in Numerical Index and filed for
 record the 17 day of April, 1997
 at 10:30 o'clock A.M., and recorded in
 Book 212 of Deeds
 on page 582
Shirley A. Hill
 Register of Deeds

2642

LOT 3, BLOCK 1
CIVIC CENTER SUBDIVISION
REPLAT OF PART BLOCK 5
ORIGINAL TOWN ADDITION
GERING, NEBRASKA
SHEET 2 OF 4

SURVEYOR'S CERTIFICATE

I, Kelly A. Beatty, a Nebraska Registered Land Surveyor, hereby certify that I have surveyed and prepared a plat of LOT 3, BLOCK 1, CIVIC CENTER SUBDIVISION, to the City of Gering, Nebraska, a Replat of the West 40 feet of Lot 3, all of Lots 4 and 5, the South 75 feet of Lot 7 and all of Lots 8, 9, and 10, Block 5, Original Town Addition to the City of Gering, Scotts Bluff County, Nebraska, and including that portion of the vacated alley between Lot 2, Block 1, Civic Center Subdivision to the City of Gering, Nebraska, and the easterly line of Lot 6, Block 5, Original Town Addition to the City of Gering, Scotts Bluff County, Nebraska, more particularly described as follows:

Beginning at the Northwest Corner of Lot 2, Block 1, Civic Center Subdivision, thence southerly on the West line of said Lot 2, on an assumed bearing of S 00°04'25"E, a distance of 140.00 feet, thence bearing N 89°29'02"E, as measured, on the West line of said Lot 2, a distance of 10.0 feet, thence bearing S 00°05'48"E, as measured, on the West line of said Lot 2, a distance of 159.83 feet, as measured, to the Southwest Corner of Lot 2, Block 1, Civic Center Subdivision, said corner also being on the northerly Right of Way line of "M" Street, as platted, thence bearing S 89°56'48"W, as measured, on the northerly Right of Way line of "M" Street, a distance of 200.07 feet, as measured, to the point of intersection with the easterly Right of Way line of 12th Street, as platted, thence bearing N 00°00'00"E, as measured, on said easterly Right of Way line of 12th Street, a distance of 75.0 feet, to the Southwest Corner of the North 65.0 feet of Lot 7, Block 5, Original Town Addition to the City of Gering, thence bearing S 89°53'48"E, as measured, a distance of 49.89 feet, as measured, to the Southeast Corner of the North 65.0 feet of Lot 7, Block 5, Original Town, thence bearing N 00°02'07"E, as measured, a distance of 65.02 feet, as measured, to the Northeast Corner of Lot 7, Block 5, Original Town Addition to the City of Gering, thence bearing N 00°00'26"W, as measured, a distance of 20.00 feet, as measured, to the Southeast Corner of Lot 6, Block 5, Original Town Addition to the City of Gering, thence bearing N 00°00'26"W, on the East line of Lot 6, Block 5, Original Town, a distance of 140.00 feet, as measured, to the Northeast Corner of Lot 6, Block 5, Original Town, said corner also being on the southerly Right of Way line of "N" Street, as platted, thence bearing S 89°56'33"E, as measured on the southerly Right of Way line of "N" Street, a distance of 139.72 feet, as measured, to the Point of Beginning, containing an area of 1.09 acres, more or less.

That the accompanying plat is a true delineation of such survey drawn to a scale of 50 feet to the inch. That all dimensions are in feet and decimals. That each lot and block has its own number. That the boundary of the plat is shown with a heavy solid line with dashed lines being for orientation purposes only. That all corners found or set are marked shown.

WITNESS MY HAND AND SEAL this 12th day of December, 19 96.
FOR THE FIRM OF M. C. SCHAFF AND ASSOCIATES, INC.

Kelly A. Beatty
Kelly A. Beatty, Nebraska Registered Land Surveyor, L. S. 476



LOT 3, BLOCK 1
CIVIC CENTER SUBDIVISION
REPLAT OF PART BLOCK 5
ORIGINAL TOWN ADDITION
GERING, NEBRASKA
SHEET 3 OF 4

2642

OWNER'S STATEMENT

We, the undersigned, being the owners of the West 40 feet of Lot 3, all of Lots 4 and 5, the South 75 feet of Lot 7, and all of Lots 8, 9, and 10, Block 5, Original Town Addition to the City of Gering, Scotts Bluff County, Nebraska, and including that portion of the alley between Lot 2, Block 1, Civic Center Subdivision to the City of Gering, Scotts Bluff County, Nebraska, and the easterly line of Lot 6, Block 5, Original Town Addition to the City of Gering, Scotts Bluff County, Nebraska, as described in the foregoing "Surveyor;s Certificate" and shown on the accompanying plat have caused such real estate to be platted as LOT 3, BLOCK 1, CIVIC CENTER SUBDIVISION, to the City of Gering, Scotts Bluff County, Nebraska.

That the foregoing plat is made with the free consent and in accordance with the desires of the undersigned owners. We herebt dedicate the easements shown on the plat to the use and benefit of the public.

Dated this 14th day of APRIL, 19 97.

City of Gering, Nebraska

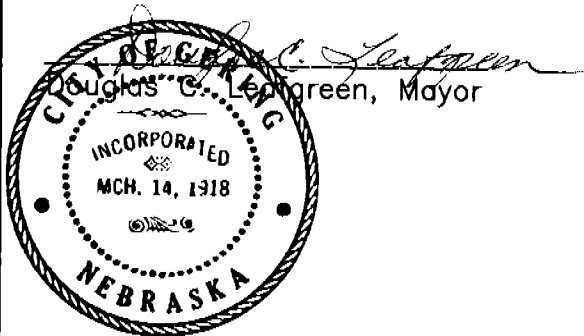

ACKNOWLEDGEMENT

STATE OF NEBRASKA)
COUNTY OF SCOTTS BLUFF)

Before me, a Notary Public, qualified and acting in said County, personally came Douglas C. Leafgreen, Mayor of the City of Gering, Nebraska, to me known to be the identical person whose signature is affixed to the foregoing "Owner's Statement" and acknowledged the execution thereof to be his voluntary act and deed and the voluntary act and deed of the City of Gering, Nebraska.

WITNESS MY HAND AND NOTARIAL SEAL this 14th day of APRIL 19 97.

Rosemarie D. Russell
Notary Public

My Commission Expires:



2642

LOT 3, BLOCK 1
CIVIC CENTER SUBDIVISION
REPLAT OF PART BLOCK 5
ORIGINAL TOWN ADDITION
GERING, NEBRASKA
SHEET 4 OF 4

APPROVAL AND ACCEPTANCE

The foregoing plat of LOT 3, BLOCK 1, CIVIC CENTER SUBDIVISION, a Replat of the West 40 feet of Lot 3, all of Lots 4 and 5, the South 75 feet of Lot 7, and all of Lots 8, 9, and 10, Block 5, Original Town Addition to the City of Gering, Scotts Bluff County, Nebraska, and including that portion of the vacated alley between Lot 2, Block 1, Civic Center Subdivision to the City of Gering, Nebraska, and the easterly line of Lot 6, Block 5, Original Town to the City of Gering, Nebraska, was approved by the City Administrator and City Engineer of the City of Gering, Nebraska, pursuant to Section 19-916, Reissue of Revised Statutes of Nebraska, as amended by Section 10 of L.B. 71, approved March 5, 1983, and amendment to Article 21, Section 21.307 by Ordinance No. 1517 to the City of Gering, Nebraska.

Don W. Baird
City Administrator



Brian R. Sweeney
City Engineer

ACKNOWLEDGEMENT

STATE OF NEBRASKA)
COUNTY OF SCOTTS BLUFF)

Before me, a Notary Public, qualified and acting in said County, personally came Don W. Baird, City Administrator of the City of Gering, to me known to be the identical person whose signature is affixed to the foregoing "Owner's Statement" and acknowledged the execution thereof to be his voluntary act and deed and the voluntary act and deed on behalf of the City of Gering, Nebraska.

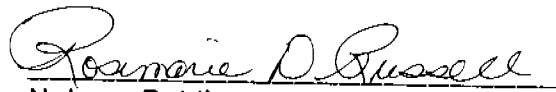
WITNESS MY HAND AND NOTARIAL SEAL this 14th day of APRIL 1997.

Notary Public

My Commission Expires: _____

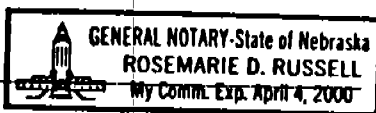

ACKNOWLEDGEMENT

STATE OF NEBRASKA)
COUNTY OF SCOTTS BLUFF)

Before me, a Notary Public, qualified and acting in said County, personally came Brian R. Sweeney, City Engineer of the City of Gering, to me known to be the identical person whose signature is affixed to the foregoing "Owner's Statement" and acknowledged the execution thereof to be his voluntary act and deed and the voluntary act and deed on behalf of the City of Gering, Nebraska.

WITNESS MY HAND AND NOTARIAL SEAL this 14th day of APRIL 1997.

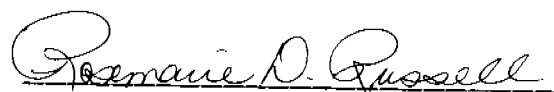
Notary Public

My Commission Expires: _____

