



2005-8809

NUM. INDEX mb  
COMPUTER gn  
PICTURED gn  
IMAGED \_\_\_\_\_

NUM PAGES 2  
DOC TAX \_\_\_\_\_ PD \_\_\_\_\_ CHG \_\_\_\_\_ RET \_\_\_\_\_  
FEES 14.50 PD \_\_\_\_\_ CHG \_\_\_\_\_ RET \_\_\_\_\_  
TOTAL 14.50 ck 14.00 cash 30  
REC'D Peggy - Summers & Assoc.  
RET \_\_\_\_\_

RECORDED  
SCOTTS BLUFF COUNTY, NE  
Date 12-7-05 Time 10:38 AM  
Inst. 2005 - 8809  
Jan A. Bauer

REGISTER OF DEEDS

**FINAL PLAT**

**LOTS 1H AND 2H, A REPLAT  
OF PART OF LOT H, SUBDIVISION OF LOT 125, HIGHLAND PARK ADDITION  
TO THE VILLAGE OF TERRYTOWN, NEBRASKA**

SITUATED IN THE SOUTHWEST QUARTER OF SECTION 26, T22N-R55W,  
SCOTTS BLUFF COUNTY, NEBRASKA

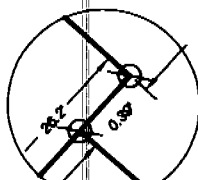

DETAIL 1  
(NOT TO SCALE)

EXCEPTED AREA AS  
DESCRIBED IN DEED BOOK  
135, PAGE 92 & 93.  
(NOT PART OF THIS REPLAT)

**STABLE CLUB ROAD**

NORTH RIGHT OF WAY LINE OF STABLE CLUB  
ROAD AS RECORDED IN DEED BOOK 133,  
PAGE 583, LOCATION SHOWN BASED ON  
SURVEY RIGHT OF WAY PLAT OF STABLE CLUB  
ROAD BY RON VOGEL

IRRIGATION DISTRICT  
DITCH CENTERLINE

**TERRY BOULEVARD**

SOUTH LINE OF SECTION 26



- EXISTING QUARTER SECTION CORNER, AS NOTED
- EXISTING 5/8" x 30" REBAR, AS NOTED
- SET 5/8" x 30" REBAR
- MEASURED DISTANCE
- RECORDED DISTANCE
- RIGHT OF WAY
- EXISTING BUILDINGS

**SURVEYOR'S CERTIFICATE**

I, Kelly A. Beatty, a Nebraska Registered Land Surveyor, hereby certify I have surveyed and prepared a plat of LOTS 1H AND 2H, A REPLAT OF PART OF LOT H, SUBDIVISION OF LOT 125, HIGHLAND PARK ADDITION, to the Village of Terrytown, Nebraska, situated in the Southwest Quarter of Section 26, Township 22 North, Range 55 West of the 6th P.M., Scotts Bluff County, Nebraska, said replat to subdivide into two lots, of original Lot H, subdivision of Lot 125, Highland Park Addition, Except for that part previously excepted out in Deed Book 135, Page 92 & 93, for well house, and Except that part of Lot H taken for Stable Club Road right of way in Deed Book 133, Page 583.

That the accompanying plat is a true delineation of said survey drawn to a scale of 50 feet to the inch. That each Lot and Block has its own number and that the boundary of the plat is shown with a heavy solid line with dashed lines being for orientation purposes only. That all corners found or set are marked as shown.

WITNESS MY HAND AND SEAL this 11<sup>th</sup> day of March, 20 05  
FOR THE FIRM OF M.C. SCHAFF & ASSOCIATES, INC.

Kelly A. Beatty  
Kelly A. Beatty, Nebraska Registered Land Surveyor, L.S. 476

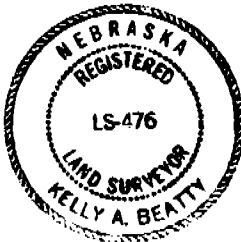

LOTS 1H AND 2H  
REPLAT OF PART OF LOT H,  
SUBDIVISION OF LOT 125,  
HIGHLAND PARK ADDITION  
SCOTTS BLUFF COUNTY, NE  
SHEET 2 OF 2

**OWNER'S STATEMENT**

We, the undersigned, being the owners of record of that part of Lot H, Subdivision of Lot 125, Highland Park Addition, situated in the Southwest Quarter of Section 26, Township 22 North, Range 55 West of the 6th P.M., Scotts Bluff County, Nebraska, as described in the foregoing 'Surveyor's Certificate' and shown on the accompanying plat have caused such real estate to be platted as LOTS 1H AND 2H, a Replat of part of Lot H, Subdivision of Lot 125, HIGHLAND PARK ADDITION, to the Village of Terrytown, Nebraska, situated in the Southwest Quarter of Section 26, Township 22 North, Range 55 West of the 6th P.M., Scotts Bluff County, Nebraska.

That the foregoing plat is made with the free consent and in accordance with the desires of the undersigned owners.

Dated this 15th day of November, 2005.

Richard E. King  
Richard E. King

Cheryl L. King  
Cheryl L. King

**ACKNOWLEDGEMENT**

STATE OF Colorado  
COUNTY OF Garfield

Before me, a Notary Public, qualified and acting in said County, personally came Richard E. King and Cheryl L. King, husband and wife, to me known to be the identical persons whose signature is affixed to the foregoing 'Owner's Statement' and acknowledged the execution thereof to be their voluntary act and deed.

WITNESS MY HAND AND SEAL THIS 15th DAY OF November, 2005.

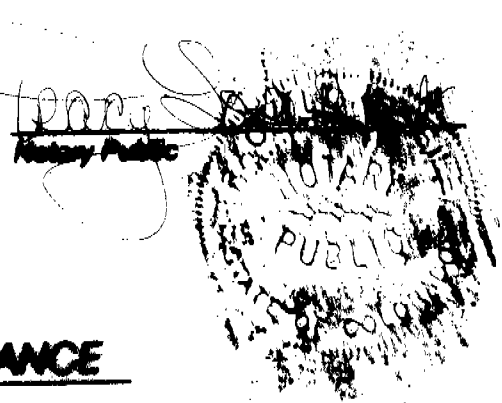

My Commission Expires 10-27-2008

**APPROVAL AND ACCEPTANCE**

The foregoing plat of LOTS 1H and 2H, a Replat of part of Lot H, Subdivision of Lot 125, HIGHLAND PARK ADDITION, to the Village of Terrytown, Nebraska, situated in the Northwest Quarter of Section 9, Township 22 North, Range 55 West of the 6th P.M., Scotts Bluff County, Nebraska, is hereby approved by the Mayor and Village Council of the Village of Terrytown, Nebraska, by resolution duly passed this 1 day of December, 2005.

[Signature]

ATTEST:

Fred W. Ruff  
Village Clerk