

SURVEYOR'S CERTIFICATE

I, Duane E. Stott, a competent surveyor of Scotts Bluff County, Nebraska, hereby certify that I have surveyed Lots C, BERGGREN-KLEVEN SUBDIVISION AND REPLAT, a Subdivision in the City of Scottsbluff, Nebraska, and prepared a plat to be known as a Subdivision of Lot C, BERGGREN-KLEVEN SUBDIVISION & REPLAT, a Subdivision in the City of Scottsbluff, Nebraska, and that the accompanying plat is a true delineation of such survey and subdivision drawn to a scale of 100 feet to the inch. That the subdivision and replat contains 0.65 acres more or less.

That all corners are marked with 3/4" x 18" iron rods or as otherwise shown. That all dimensions are in feet and decimals and all Lots and Blocks bear their own number. That the Boundary of the survey is shown on the plat with a heavy solid line.

WITNESS MY HAND AND SEAL this 30th day of November, 1978

FOR THE FIRM OF M.C. SCHAFF & ASSOCIATES, INC.

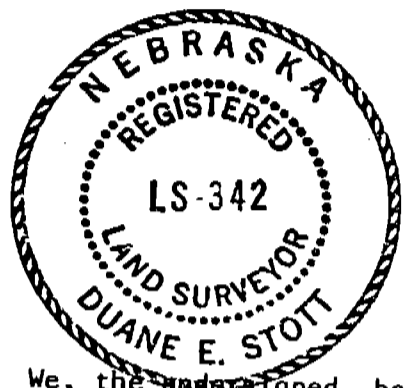

Duane E. Stott
Duane E. Stott, Nebraska Registered
Land Surveyor, L.S. 342

OWNER'S STATEMENT

We, the undersigned, being the Owners of Lot C, BERGGREN-KLEVEN SUBDIVISION AND REPLAT, a Subdivision in the City of Scottsbluff, Nebraska, as described in the foregoing "Surveyor's Certificate" and shown by the accompanying plat, have caused such real estate to be surveyed, subdivided and platted as "SUBDIVISION OF LOT 'C', BERGGREN-KLEVEN SUBDIVISION AND REPLAT", a Subdivision in the City of Scottsbluff, Nebraska.

The foregoing subdivision and replat is made with the free consent and in accordance with the desires of the undersigned Owners.

DATED this 30th day of November, 1978.

Wayne Saunders
Wayne Saunders

Patricia A. Saunders
Patricia A. Saunders

Gary R. Young
Gary R. Young

Neta J. Young
Neta J. Young

ACKNOWLEDGEMENT

STATE OF NEBRASKA)
SCOTTS BLUFF COUNTY) ss

Before me, a Notary Public, qualified and acting in said County, personally came Gary R. Young and Neta J. Young, Husband and Wife, known to me to be the identical persons whose signatures are affixed to the foregoing "Owner's Statement" and acknowledged the execution thereof to be their voluntary act and deed.

WITNESS MY HAND AND NOTARIAL SEAL this 1 day of December, 1978.

My Commission expires: May 10, 1980

Laura C. Young
Notary Public

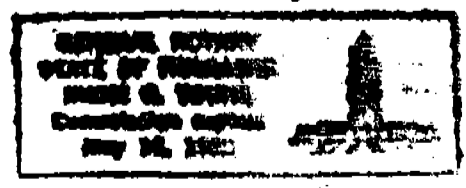

SUBDIVISION OF LOT "C"
BERGGREN-KLEVEN SUBDIVISION & REPLAT
A SUBDIVISION IN THE CITY OF
SCOTTSBLUFF, NEBRASKA

Sheet 3 of 3

6928

ACKNOWLEDGEMENT

STATE OF NEBRASKA)
SCOTTS BLUFF COUNTY) ss

Before me, a Notary Public, qualified and acting in said County, personally came Wayne Saunders and Patricia A. Saunders, husband and wife, to me known to be the identical persons whose signatures are affixed to the foregoing "Owner's Statement" and acknowledged the execution thereof to their voluntary act and deed.

WITNESS MY HAND AND NOTARIAL SEAL this 1 day of December, 1978.

Leona C. Young

Notary Public.

My Commission expires: May 16, 1980

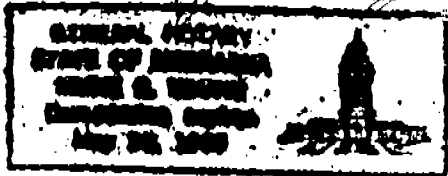

APPROVAL AND ACCEPTANCE

The foregoing plat of "SUBDIVISION OF LOT 'C', BERGGREN-KLEVEN SUBDIVISION AND REPLAT", hereby approved by the Mayor and City Council of the City of Scottsbluff, Nebraska, by resolution duly passed this 11th day of December, 1978.

Harold E. Dummer

Mayor

ATTEST:

A. L. Ferguson

City Clerk



State of Nebraska, Scotts Bluff County ss.
Entered in Numerical Index and filed for
record the 18 day of December, 1978
at 10.00 o'clock 9 M., and recorded in
Book 160 of Deeds
on page 347
Mary J. Tolha
Register of Deeds
By _____ Deputy