

# DEED RECORD No. 16

See Replat Lots 231+232+alley  
Bk 192-473

94277-The K-B Printing Company, Omaha

## MITCHELL CEMETERY

659.5' Fence

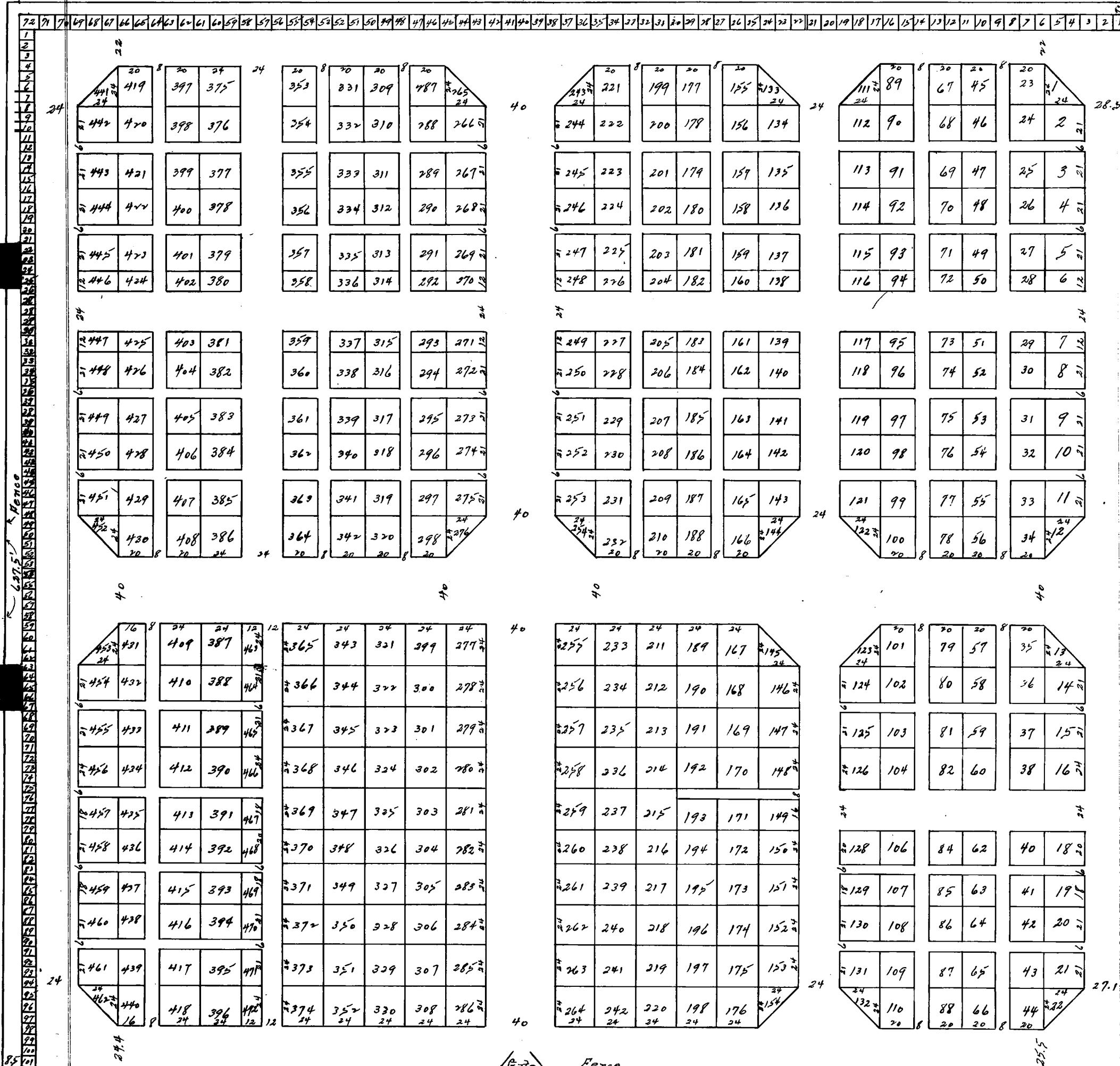

Approved by the City Council  
of the City of Mitchell,  
Nebraska, May 11, 1925.  
J E Keebaugh, Mayor  
Attest: H E Russell City Clerk.

State of Nebraska, Scotts Bluff County, ss.  
Entered on Numerical Index and filed for record  
the 1st day of June, 1925, at 9: o'clock A.M. and  
recorded in Book 16 of Deeds on Page 441.  
R. G. Neeley, Register of Deeds.

I, A B McCoskey, do hereby certify that on the 21st & 22nd of April, 1925, I resurveyed Mitchell Cemetery, which is the South West Quarter (SW $\frac{1}{4}$ ) of the Southeast Quarter (SE $\frac{1}{4}$ ) of Section Sixteen (16) T 23 N R 56 West of the 6th P.M. Nebraska, Described as follows: Beginning at a point 33 ft North of the  $\frac{1}{4}$  corner between Sections 16 & 21 said Tp & Range, Thence North (va 15°E) 627.5 ft., thence East 659.5', thence South 627', thence west 660.8' to the place of beginning. Said tract as subdivided consists of 472 lots, streets & alleys; that the dimensions of the lots and the widths of the streets and alleys are as shown by figures on the above plat. Each lot bears its own number. Also 72 lots on the North 9'x9', and 101 lots on the West 6'x9', each lot bearing its own number as shown on the plat.

A B McCoskey,  
Surveyor.

#####