

GARDEN OF MEDITATION SUNSET MEMORIAL PARK

NE Corner
of Section 8,
T22N, R55W

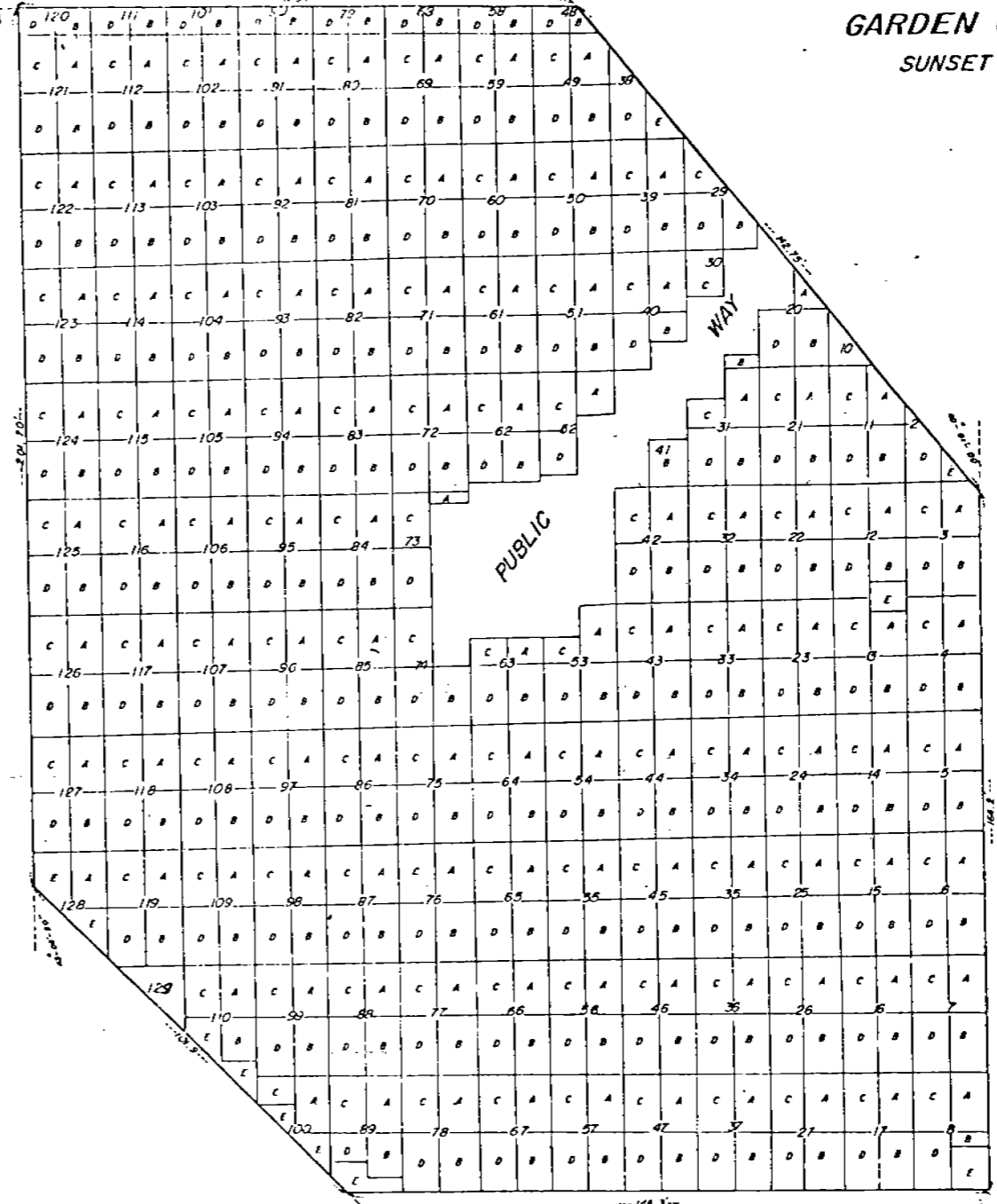

MARKER AND
SPACE LOCATION

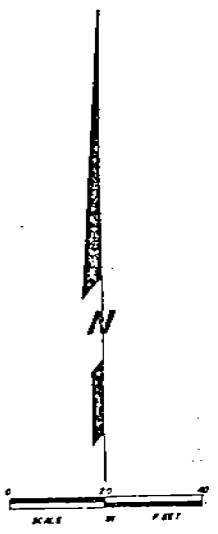
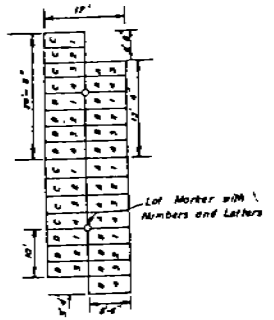

4982

State of Nebraska, Scotts Bluff County ss.
 Entered in Numerical Index and filed for
 record the 7 day of September 1978
 at 12:30 o'clock P.M., and recorded in
 Book 159 of Ord.
 on page 254
 BY Mary Jo Kelly
 Register of Deeds
 Deputy

10/25
11

SURVEYOR'S CERTIFICATE

I, Duane E. Stott, a competent surveyor of Scotts Bluff County, Nebraska, hereby certify that I have surveyed and prepared a plat of a tract of land in the Northeast Quarter of Section 8, Township 22 North, Range 55 West of the 6th P.M., Scotts Bluff County, Nebraska, and that such tract shall be recorded and known as "Garden of Meditation", an Addition to Sunset Memorial Park, a cemetery in Scotts Bluff County, Nebraska, the boundary being more particularly described as follows:

With reference to the Northeast corner of Section 8; thence, southerly on the East line of said Section, a distance of 1408.34 feet; thence, a deflection angle right of 90 degrees 00 minutes 00 seconds, a distance of 297.37 feet; thence, a deflection angle right of 89 degrees 47 minutes 50 seconds, a distance of 12.10 feet to the TRUE POINT OF BEGINNING; thence, continuing northerly on the last described course, a distance of 164.20 feet; thence, a deflection angle left of 40 degrees 01 minutes 00 seconds, a distance of 143.75 feet; thence, a deflection angle left of 49 degrees 37 minutes 30 seconds, a distance of 129.10 feet; thence, a deflection angle left of 90 degrees 26 minutes 50 seconds, a distance of 201.70 feet; thence, a deflection angle left of 45 degrees 08 minutes 50 seconds, a distance of 101.90 feet; thence, a deflection angle left of 44 degrees 27 minutes 30 seconds, a distance of 148.30 feet to the point of beginning, containing an area of 1.21 acres more or less.

That the accompanying plat is a true delineation of such survey drawn to a scale of 20 feet to the inch and that all exterior boundary corners are marked with 3/4" x 18" iron bars and that all Lot markers are marked with numbered discs which were not established as part of this survey, but were used as control for determination of the exterior boundary.

WITNESS MY HAND AND SEAL this 20th day of July, 19 78.



FOR THE FIRM OF M.C. SCHAFF & ASSOCIATES, INC.

Duane E. Stott
Duane E. Stott, Nebraska Registered
Land Surveyor, L.S. 342

OWNER'S STATEMENT

We, the undersigned, being the Owners of that part of the Northeast Quarter of Section 8, Township 22 North, Range 55 West of the 6th P.M., Scotts Bluff County, Nebraska, as described in the foregoing "Surveyor's Certificate" and shown in the accompanying plat have caused such real estate to be surveyed and platted as "Garden of Meditation".

DATED this 7th day of August, 19 78.

SUNSET MEMORIAL PARK CEMETERY ASSOCIATION

Morgan L. Welch
Morgan Welch, Trustee

Jo Ann Welch
Joann Welch, Secretary

256

4982

GARDEN OF MEDITATION
SUNSET MEMORIAL PARK
NORTHEAST QUARTER
SECTION 8-22-55
SCOTTS BLUFF COUNTY, NEBRASKA

ACKNOWLEDGEMENT

STATE OF NEBRASKA)
SCOTTS BLUFF COUNTY) ss

Before me, a Notary Public, qualified and acting in said County, personally came Morgan Welch, Trustee, and Joann Welch, Secretary, of Sunset Memorial Park Cemetery Association, to me known to be the identical persons whose signatures are affixed to the foregoing Owner's Statement and acknowledge the execution thereof to be their voluntary act and deed and the voluntary act and deed of said Association.

WITNESS MY HAND AND NOTARIAL SEAL this 7th day of August, 1978.

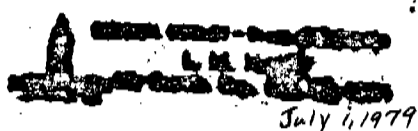

L M Huhn
Notary Public

My Commission expires: _____

APPROVAL AND ACCEPTANCE

The foregoing plat of "GARDEN OF MEDITATION", hereby approved by the Scotts Bluff County Board of Commissioners by Resolution duly passed this 28th day of August, 1978.



Edward A. Jekwood
Chairman of the Board

ATTEST:

Marjorie S. Steffen
County Clerk
Deputy

256