

REPLAT OF LOTS 7 THRU 12, 29 THRU 34, 51 THRU 53, 73 THRU 78, 95 THRU 100, 117 THRU 122, 139 THRU 144, 161 THRU 166, 183 THRU 188, 205 THRU 210, 227 THRU 230, 249 THRU 252 AND STREET AND ALLEYS ADJUTING IN THE MITCHELL CEMETERY.

MITCHELL CEMETERY

3010

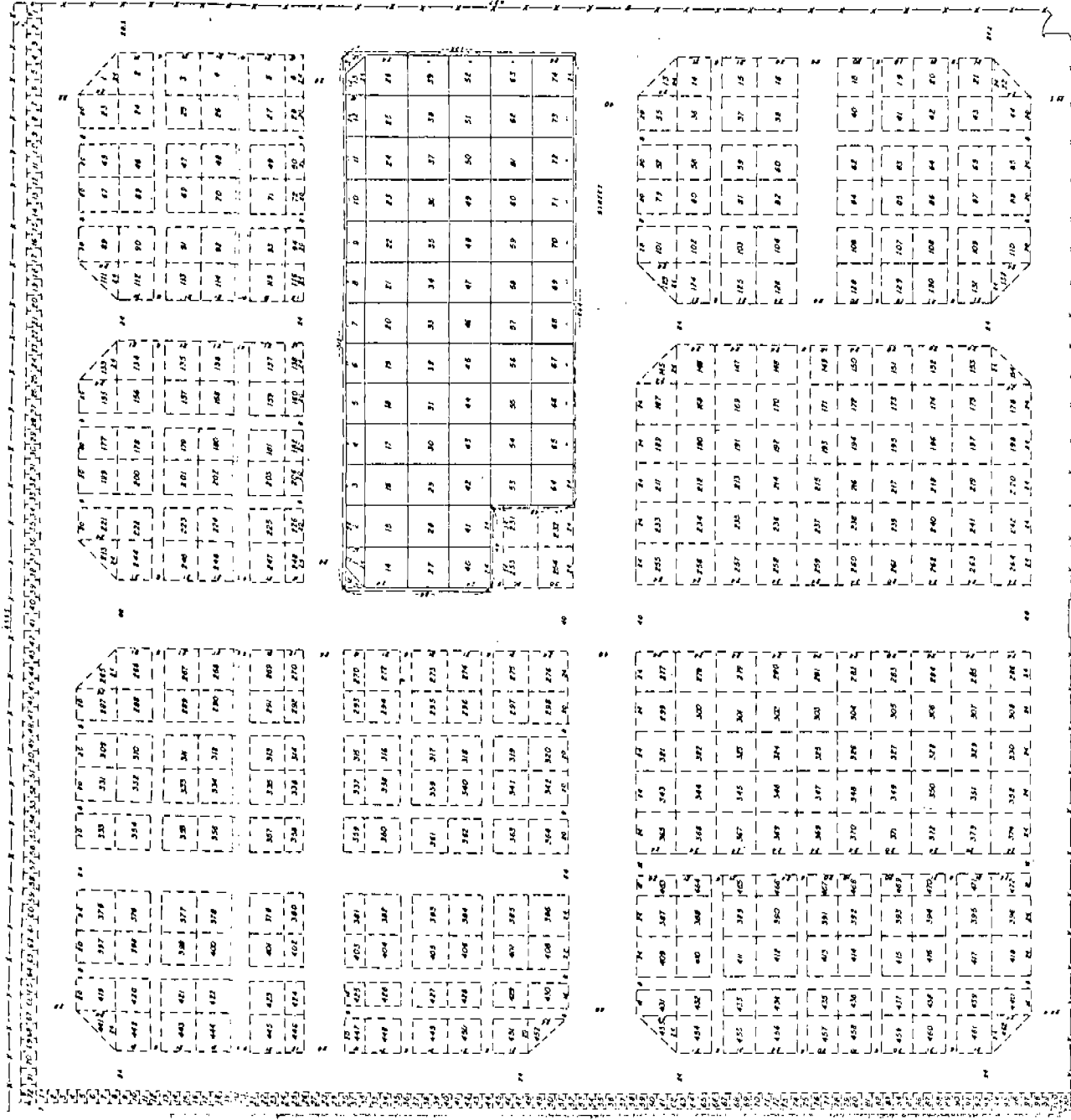

State of Nebraska, Scotts Bluff County ss.
 Entered in Numerical Index and filed for
 record the 22 day of June, 1976
 at 9:15 o'clock A. M., and recorded in
 Book 150 of Deeds
 on page 643
Mary J. Kelly
 Register of Deeds

I, M. C. Schaff, a competent surveyor of Scotts Bluff County, Nebraska do hereby certify that I have surveyed Lots 7 thru 12, 29 thru 34, 51 thru 53, 73 thru 78, 95 thru 100, 117 thru 122, 139 thru 144, 161 thru 166, 183 thru 188, 205 thru 210, 227 thru 230, 249 thru 252, Street and Alleys adjoining thereon, and that such survey cause said Lots, Street and Alleys to be known as lots 7 thru 74 as shown by the accompanying Plat. That the Plat is a true and correct indication of such survey drawn to a Scale of 1 inch to 30 feet that the corners of each lot are marked with iron rods.

WITNESS MY HAND AND SEAL this 1st day of October, 1976

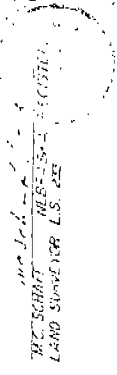

The accompanying Plat approved by the City Council of the City of Mitchell by resolution duly passed this 6 day of April 1976
M. E. Mitchell
 MAYOR