

Note: now platted as Lots 1A, 1B + 1C - Subdivision of Lot 1 Block 3.

2014

### GEORGE BALTES ADDITION TO THE CITY OF SCOTT'S BLUFF SCOTT'S BLUFF COUNTY, NEBRASKA

LOTS 2, 3, 4, 5 AND 6, BLOCK 3  
LOT 1, BLOCK 7  
144 ACRES

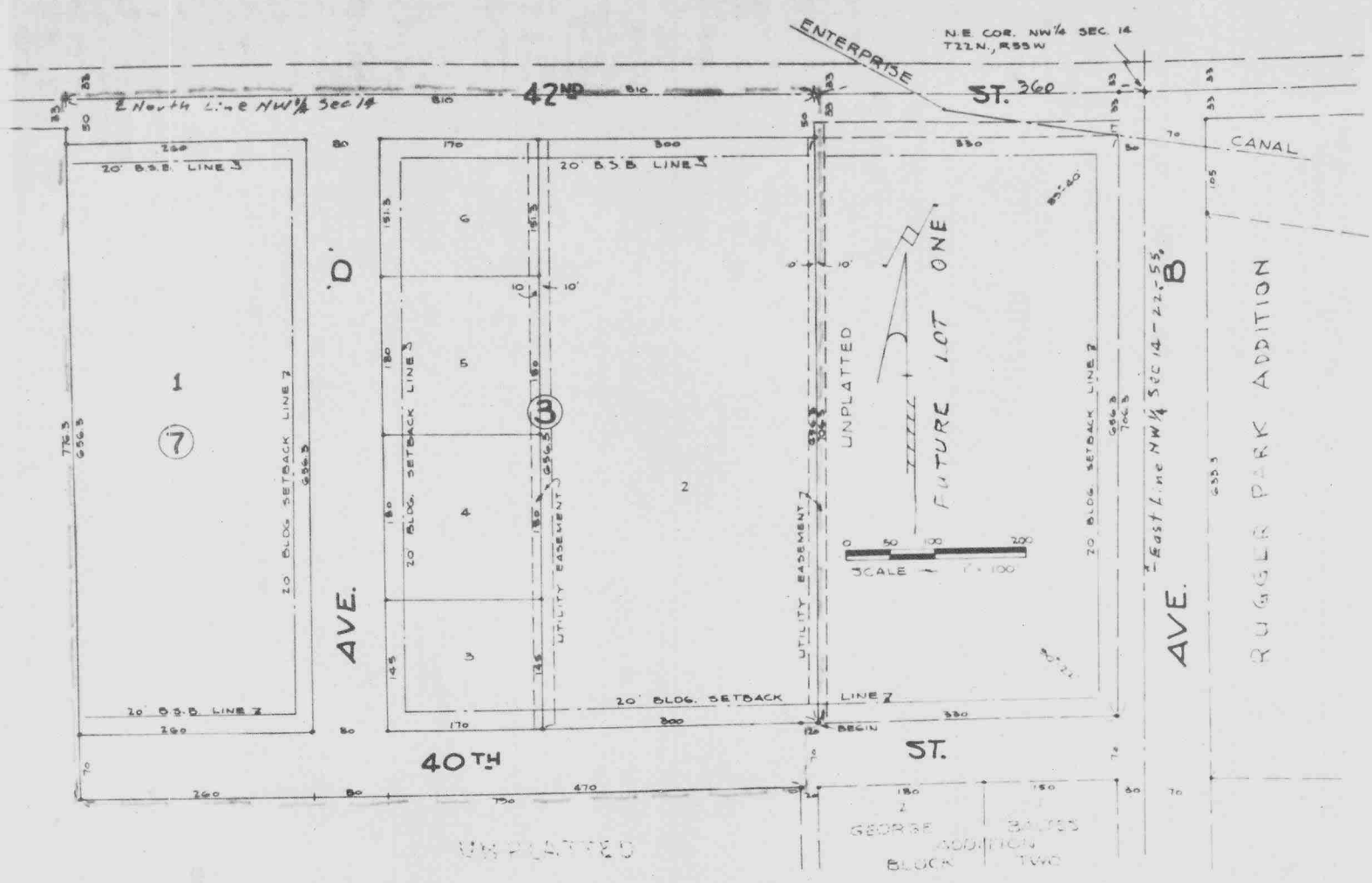

## SURVEYOR'S CERTIFICATE

I, E.Y. GRUPE, A COMPETENT SURVEYOR OF SCOTTS BLUFF COUNTY, NEBRASKA, DO HEREBY CERTIFY THAT ON THE 20<sup>TH</sup> DAY OF MARCH, 1967, I COMPLETED A SURVEY OF LOTS 2, 3, 4, 5 AND 6, BLOCK 3, AND LOT 1, BLOCK 7, GEORGE BALTES ADDITION TO THE CITY OF SCOTTSBLUFF, NEBRASKA, AND PARTS OF ALLEYS, STREETS AND WAYS AS SHOWN BY THE ACCOMPANYING PLAT; ALL SITUATED ON A PART OF THE NORTHWEST QUARTER (NW<sup>1</sup>/<sub>4</sub>), SECTION FOURTEEN (14), TOWNSHIP TWENTY-TWO (22) NORTH, RANGE FIFTY-FIVE (55) WEST OF THE 6<sup>TH</sup> P.M., IN SCOTTS BLUFF COUNTY, NEBRASKA, MORE PARTICULARLY DESCRIBED AS FOLLOWS:

BEGINNING AT A POINT 360 FEET WEST ON THE NORTH LINE AND 706.3 FEET SOUTH ON A LINE PARALLEL TO THE EAST LINE, OF THE NORTHEAST CORNER OF THE NORTHWEST QUARTER (NW<sup>1</sup>/<sub>4</sub>), SECTION 14, TOWNSHIP 22 NORTH, RANGE 55 WEST OF THE 6<sup>TH</sup> P.M.;

THENCE WEST ON A LINE PARALLEL TO THE NORTH LINE OF SAID NORTHWEST QUARTER (NW<sup>1</sup>/<sub>4</sub>) 20 FEET;

THENCE SOUTH ON A LINE PARALLEL TO THE EAST LINE OF SAID NORTHWEST QUARTER (NW<sup>1</sup>/<sub>4</sub>) 70 FEET;

THENCE WEST ON A LINE PARALLEL TO THE NORTH LINE OF SAID NORTHWEST QUARTER (NW<sup>1</sup>/<sub>4</sub>) 790 FEET;

THENCE NORTH ON A LINE PARALLEL TO THE EAST LINE OF SAID NORTHWEST QUARTER (NW<sup>1</sup>/<sub>4</sub>) 776.3 FEET TO THE NORTH LINE OF SAID NORTHWEST QUARTER (NW<sup>1</sup>/<sub>4</sub>);

THENCE EAST ON SUCH NORTH LINE 810 FEET;

THENCE SOUTH AND PARALLEL TO THE EAST LINE OF SAID NORTHWEST QUARTER (NW<sup>1</sup>/<sub>4</sub>) 706.3 FEET, TO THE POINT OF BEGINNING, CONTAINING 14.4 ACRES.

THAT THE ACCOMPANYING PLAT IS A CORRECT DELINEATION OF SUCH SURVEY DRAWN TO A SCALE OF 100 FEET TO THE INCH.

THAT ALL DIMENSIONS ARE SHOWN IN FEET AND DECIMALS.

THAT ALL BLOCK CORNERS ARE MARKED WITH 5/8" x 36" IRON RODS AND ALL OTHER CORNERS ARE MARKED WITH 5/8" x 18" IRON RODS.

WITNESS MY HAND AND SEAL THIS 20<sup>TH</sup> DAY OF MARCH, 1967.

*E. Y. Grupe*

E. Y. GRUPE SCOTTSBLUFF, NEBRASKA  
NEBRASKA REGISTERED LAND SURVEYOR L.S. 69

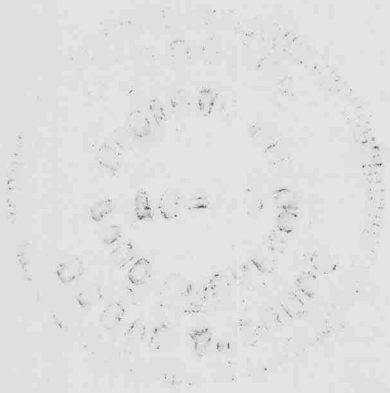

DEDICATION

WE, THE UNDERSIGNED, BEING THE OWNERS OF THAT PART OF THE NORTHWEST QUARTER (NW<sup>1</sup>/<sub>4</sub>) OF SECTION 14, TOWNSHIP 22 NORTH, RANGE 55 WEST OF THE 6<sup>TH</sup> P.M., IN SCOTTS BLUFF COUNTY, NEBRASKA, HAVE CAUSED SUCH REAL ESTATE TO BE SURVEYED AND PLATTED AS LOTS 2, 3, 4, 5 AND 6, BLOCK 3, AND LOT 1, BLOCK 7, GEORGE BALTES ADDITION TO THE CITY OF SCOTTSBLUFF, SCOTTS BLUFF COUNTY, NEBRASKA, AS SHOWN BY THE ACCOMPANYING PLAT AND SURVEYOR'S CERTIFICATE.

THE ABOVE DESCRIBED AND FOREGOING GEORGE BALTES ADDITION AND THE EASEMENTS, STREETS, AVENUES AND ALLEYS AS APPEARS ON THIS PLAT IS MADE WITH THE FREE CONSENT AND IN ACCORDANCE WITH THE DESIRES OF THE UNDERSIGNED OWNERS.

WE HEREBY DEDICATE THE STREETS, AVENUES, ALLEYS AND EASEMENTS DESIGNATED UPON AND REFERRED TO IN THE SAID PLAT TO THE USE AND BENEFIT OF THE PUBLIC AND FURTHER ANNEX AND MAKE SAID REAL ESTATE A PART OF THE CITY OF SCOTTSBLUFF, NEBRASKA.

DATED THIS 30<sup>TH</sup> DAY OF MARCH, 1967.

METROPOLITAN DEVELOPMENT CO.

Bernhard Kleven  
BERNHARD KLEVEN, PRESIDENT

Robert Berggren  
ROBERT BERGGREN, SECRETARY

GRA-MAR INC.

Reuben Sitzman  
REUBEN SITZMAN, PRESIDENT

Melinda Gost  
SECRETARY

SCOTTS BLUFF COUNTY

Harold Ledingham  
HAROLD LEDINGHAM, CHAIRMAN,  
SCOTTS BLUFF CO. BOARD OF COMMISSIONERS

Melvin Maxwell  
MELVIN MAXWELL, CO. CLERK

EMMA BALTES SIMONTON AND LARRY SIMONTON (W&H); LYDIA BALTES, WIFE OF LAWRENCE G. BALTES; HAROLD R. BALTES AND IDA BALTES, (H&W); MAMIE BALTES FEIDLER, FORMERLY MAMIE BALTES BOONE, AN UNMARRIED PERSON; ROBERT GEORGE BALTES AND ELAINE BALTES, (H&W); RICHARD LEE BOONE AND MOLLIE BOONE, (H&W); RITA GERALDINE BALTES BARKO AND ARTHUR BARKO, (W&H); THOMAS LEE BALTES AN UNMARRIED PERSON; KENNETH JOHN BALTES AND JANET BALTES, (H&W) AND JUNE MURPHY FORMERLY JUNE BOONE AND HAROLD MURPHY, (W&H).

BY Lawrence G. Baltus  
LAWRENCE G. BALTUS, ATTORNEY IN FACT  
Lawrence G. Baltus  
LAWRENCE G. BALTUS

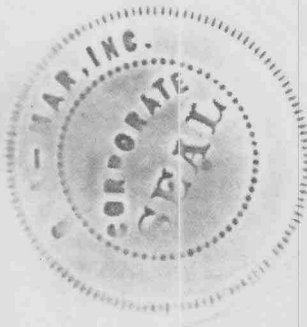



ACKNOWLEDGEMENT

STATE OF NEBRASKA )  
SCOTTS BLUFF COUNTY ) ss

2014

BEFORE ME, A NOTARY PUBLIC QUALIFIED AND ACTING IN SAID COUNTY, PERSONALLY CAME BERNHARD KLEVEN, PRESIDENT OF METROPOLITAN DEVELOPMENT COMPANY, A CORPORATION; REUBEN SITZMAN, PRESIDENT OF GRA-MAR, INC., A CORPORATION; HAROLD LEDINGHAM, CHAIRMAN OF SCOTTS BLUFF COUNTY BOARD OF COMMISSIONERS, NEBRASKA; AND LAWRENCE G. BALTES, ATTORNEY IN FACT FOR EMMA BALTES SIMONTON AND LARRY SIMONTON (W&H); LYDIA BALTES; HAROLD R. BALTES AND IDA BALTES (H&W); MAMIE BALTES FEIDLER, FORMERLY MAMIE BALTES BOONE, AN UNMARRIED PERSON, ROBERT GEORGE BALTES AND ELAINE BALTES (H&W); RICHARD LEE BOONE AND MOLLIE BOONE (H&W); RITA GERALDINE BALTES BARKO AND ARTHUR BARKO (W&H); THOMAS LEE BALTES, AN UNMARRIED PERSON; KENNETH JOHN BALTES AND JANET BALTES (H&W); AND JUNE MURPHY, FORMERLY JUNE BOONE AND HAROLD MURPHY (W&H); AND LAWRENCE G. BALTES, INDIVIDUALLY TO ME KNOWN TO BE THE IDENTICAL PERSONS WHO SIGNED THE FOREGOING INSTRUMENTS AS SUCH OFFICERS AND AS THE VOLUNTARY ACT AND DEED OF SAID METROPOLITAN DEVELOPMENT COMPANY, A CORPORATION, GRA-MAR, INC., A CORPORATION, COUNTY BOARD OF COMMISSIONERS, SCOTTS BLUFF COUNTY, NEBRASKA, AND LAWRENCE G. BALTES, AS ATTORNEY IN FACT AND AS AN INDIVIDUAL.

WITNESS MY HAND AND SEAL THIS 25 DAY OF MAY, 1967.

Robert E Berggren  
NOTARY PUBLIC

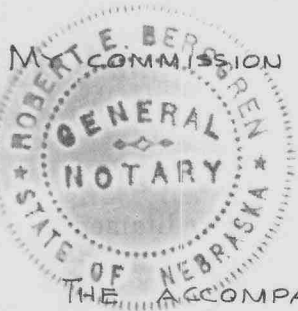

APPROVAL

THE ACCOMPANYING PLAT AND DEDICATION APPROVED AND ACCEPTED BY THE MAYOR AND CITY COUNCIL OF THE CITY OF SCOTTSBLUFF, NEBRASKA, BY RESOLUTION DULY PASSED THIS 26th DAY OF June, 1967.

C. A. Thomas  
MAYOR

ATTEST: H. L. Ferguson  
CITY CLERK



2014

NUMERICAL  
GENERAL  
TAX REG.  
PICTURED

STATE OF NEBRASKA }  
SCOTTS BLUFF COUNTY } ss.

Entered on Numerical Index and filed for

record the 17 day of July  
19 67, at 9:00 o'clock P. M., and

recorded in Book 124 of

Records on Page 98

Mary Jo Ellis  
Register of Deeds

By Janis M. Sanyard Deputy